

Go to www.vtechphones.com for the latest VTech product news.

VM342-2 Full Color Video Monitor with Wide-Angle Lens



vtech® User's manual

Congratulations

on purchasing your new VTech product. Before using this product, please read **Important safety instructions**.

This manual has all the feature operations and troubleshooting necessary to install and operate your new VTech product. Please review this manual thoroughly to ensure proper installation and operation of this innovative and feature rich VTech product.

For support, shopping, and everything new at VTech, visit our website at www.vtechphones.com.

What's in the box

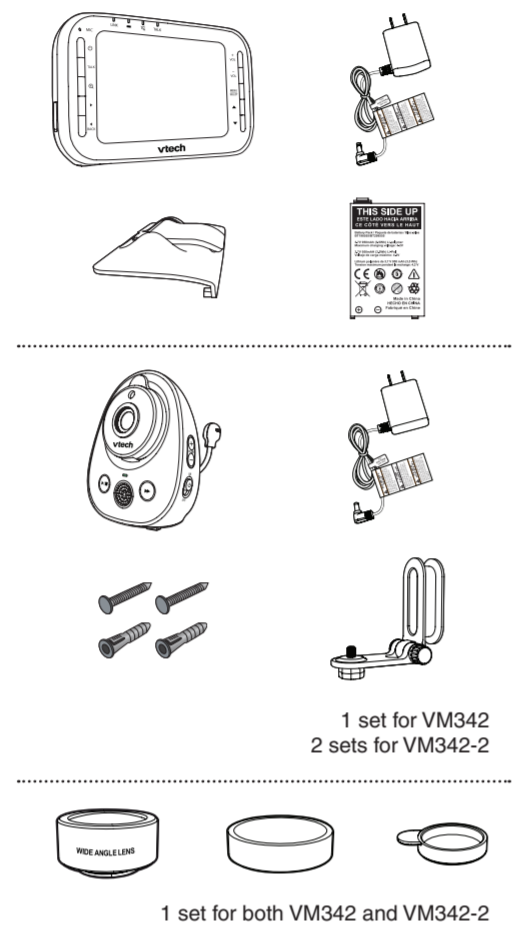

1	LED lights • Indicate the different statuses of the parent unit. For details, refer to Parent unit lights .
2	Microphone
3	On/off • Press and hold to power on. • Press and hold again to power off.
4	TALK • Press and hold to talk to the selected baby unit in SINGLE-CAM or PATROL mode.
5	Zoom • Press to zoom in or out while viewing image in SINGLE-CAM or PATROL mode.
6	• While in a menu, press to choose an item. • While viewing zoomed image, press and hold to move the zoomed image rightward. • While in SPLIT mode, press to move the selection box rightward.
7	BACK • While in a menu, press to return to the main menu or idle screen. • While viewing zoomed image, press and hold to move the zoomed image leftward. • While in SPLIT mode, press to move the selection box leftward.
8	VIEW / LCD ON/OFF • Press and hold to turn off the parent unit screen. • Press to view the image of the next baby unit in SINGLE-CAM or PATROL mode. PATROL • Press to turn on or off the PATROL mode. SPLIT • Press to turn on or off the SPLIT mode.

Install the battery

The parent unit runs on rechargeable battery or AC power. To continuously monitor your baby, make sure you use both battery and AC power at the same time. With the battery alone, the parent unit can cordlessly run for a short time only.

NOTES

- Use only the battery supplied with this product.
- Make sure the electrical outlets are not controlled by wall switches.
- The power adapters are intended to be correctly oriented in a vertical or floor mount position. The prongs are not designed to hold the plug in place if they are plugged into a ceiling, under-the-table or cabinet outlet.
- Make sure the parent unit, the baby unit and the power adapter cords are out of reach of children.

Install the battery as shown below.

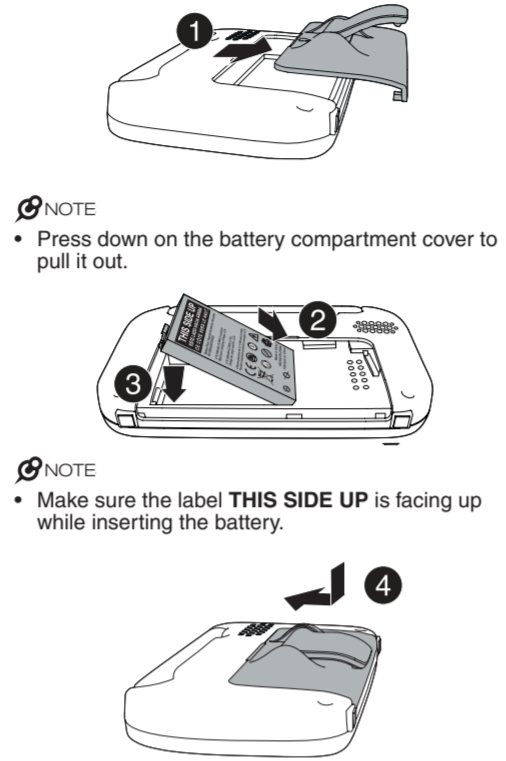

Replace the battery

To replace the battery, press down on the battery compartment cover and pull it out, then follow the steps above to install the battery.

Connect and charge the battery

NOTES

- Use only the power adapters supplied with this product.
- Make sure the electrical outlets are not controlled by wall switches.
- The power adapters are intended to be correctly oriented in a vertical or floor mount position. The prongs are not designed to hold the plug in place if they are plugged into a ceiling, under-the-table or cabinet outlet.
- Make sure the parent unit, the baby unit and the power adapter cords are out of reach of children.

Connect the baby monitor

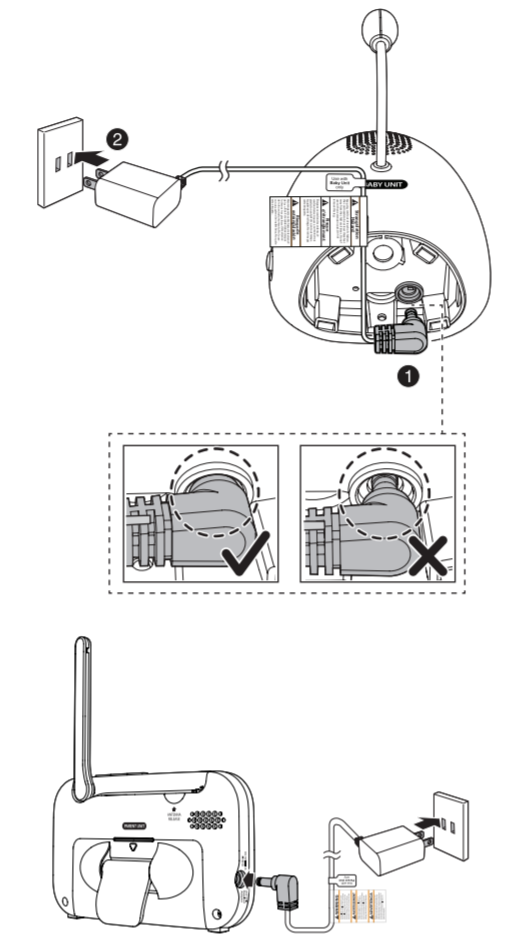

Charge the parent unit battery

When you have connected the parent unit and installed its battery for the first time or after power outage, the parent unit powers on automatically. The battery icon indicates the battery status (see the following table).

NOTES

- The parent unit battery is fully charged after 3 hours of continuous charging.
- It takes longer to charge the battery when the parent unit is turned on. To shorten the charging time, turn the parent unit off while charging.
- The standby time varies depending on the sensitivity level you set, your actual use and the age of the battery.

Battery indicators	Battery status	Action
The battery icon is off and displays.	No battery is installed but operates using AC power, or the battery has been installed incorrectly. (at least 30 minutes).	Install the parent unit battery. Charge without interruption (at least 30 minutes).
The screen displays Battery low at Parent Unit and light flashes.	The battery has very little charge and may be used for only a short time.	Charge without interruption (about 30 minutes).
The battery icon becomes solid.	The battery is fully charged.	To keep the battery charged, connect it to AC power when not in use.

Before use

NOTE

- This baby monitor is intended as an aid. It is not a substitute for proper adult supervision, and should not be used as such.

Test your baby monitor

You may test the baby monitor before initial use, and at regular times thereafter.

CAUTION

- For hearing protection, make sure the parent unit is more than 3 feet (1 meter) away from the baby unit. If you hear any high-pitched noise, move the parent unit further until the noise stops. You can also press **vol** on the parent unit to lower or mute the noise.

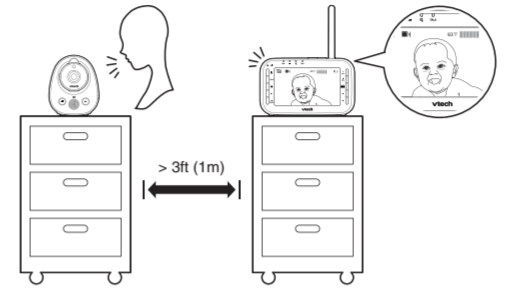

1. Make sure your baby units and parent unit are on.
2. The parent unit displays images from the baby unit.
 - Speak towards the baby unit microphone. You will hear the sound at the parent unit.
3. If you have two baby units, press **VIEW** on your parent unit. The screen switches to other baby units. Then, repeat step 2.

NOTE

- When the parent unit displays **LINK** and then **No link to CAM #** (# represents the baby unit number), and the **LINK** LED light flashes, move the parent unit closer to the baby unit (observe the minimum distance of 3 feet/ 1 meter). You can also check if the baby monitor is connected to a live power socket and switched on.

TIP

- Increase the parent unit speaker volume if you cannot hear the sounds transmitted from the baby unit.

Positioning the baby monitor

CAUTION

- Keep the baby units out of the reach of your baby. Never place or mount the baby units inside the baby's crib or playpen.

NOTE

- To avoid interference from other electronic devices, place your baby monitor far away from devices such as wireless routers, microwaves, cell phones and computers.
1. Place the baby units more than 3 feet (1 meter) away from your baby.

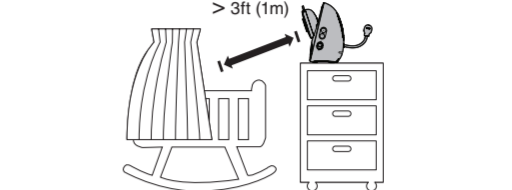

2. Adjust the angle of the baby unit camera to aim at your baby.



3. Bend down the temperature sensor so that it stays away from baby unit to avoid deviation of temperature detection.

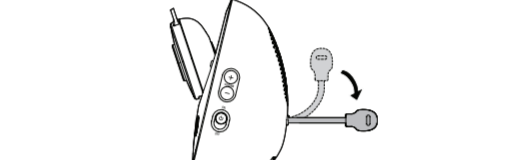

4. Place the parent unit more than 3 feet (1 meter) away from the baby units.

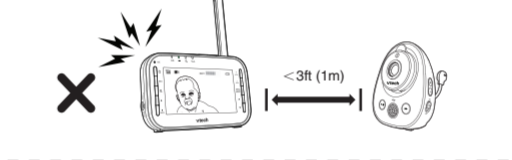
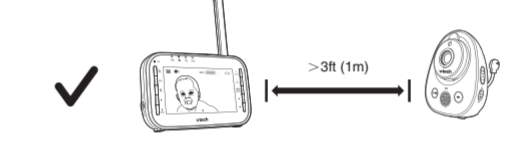

CAUTION

- The default volume of your parent unit is level 4, and the maximum volume is level 7. If you experience high-pitched screaming noise from your baby monitor while positioning:
 - Make sure your baby units and parent unit are more than 3 feet (1 meter) apart, OR
 - Turn down the volume of your parent unit.

Operating range

The operating range of the baby monitor is up to 1,000 feet (300 meters) outdoors or 160 feet (50 meters) indoors. The actual operating range may vary depending on the environmental conditions and other interferences such as walls, doors and other obstructions.

Install the lens (optional)

The wide-angle lens (VM101) provided allows you to view more of your baby's room from the parent unit screen. Install the wide-angle lens onto the baby unit camera as shown below.

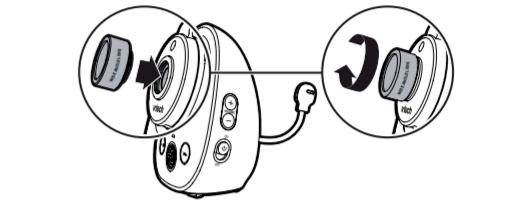

Remove the lens

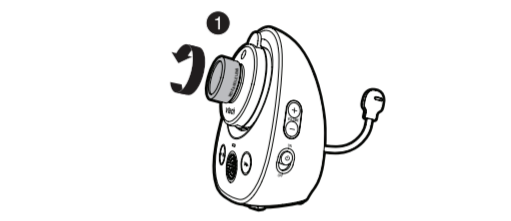

NOTES

- When the lens is not in use, cover both sides of the lens with the lens covers provided to avoid scratches.
- You can purchase and install an extra new wide-angle lens (VM101) onto your baby unit if necessary.

Overview

Baby unit overview

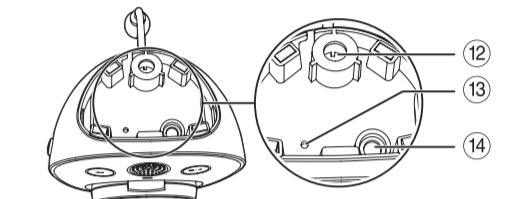
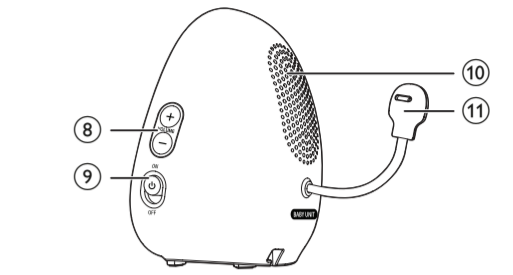
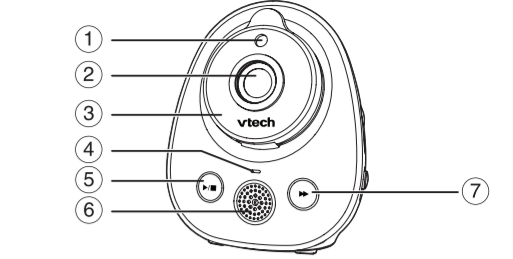

1	Light sensor
2	Camera
3	Infrared LEDs
4	ON/OFF light • On when the baby unit is turned on. • Flashes when the baby unit is not being viewed, or when the link to the parent unit is lost.
5	Play/Stop • Press to play or stop lullaby on the baby unit.
6	Microphone
7	Skip • Press to play the next lullaby.

8	+ VOLUME - • Press to adjust the speaker volume. It determines the lullaby volume and talkback volume transmitted from parent unit.
9	ON/OFF switch • Slide to turn on or off the baby unit.
10	Speaker
11	Temperature sensor
12	Threaded socket • For wall mount installation use.
13	PAIR • Your baby units and parent unit provided are already paired.
14	Power jack

9	+ VOL • Press to increase the parent unit speaker volume.
10	- VOL • Press to decrease the parent unit speaker volume.
11	MENU/SELECT • Press to enter the menu. • While in a menu, press to choose an item, or save a setting.
12	Up arrow • While in a menu, press to scroll up. • While viewing zoomed image, press and hold to move the zoomed image upward. • While in SPLIT mode, press to move the selection box upward.
13	Down arrow • While in a menu, press to scroll down. • While viewing zoomed image, press and hold to move the zoomed image downward. • While in SPLIT mode, press to move the selection box downward.
14	Antenna
15	Stand
16	Speaker
17	Power jack
18	Battery compartment cover

Parent unit lights

- **LINK**
• On when the parent unit is linked to the baby unit.
• Flashes when the link to the baby unit being viewed in **SINGLE-CAM** or **PATROL** mode is lost; or when the link to at least one baby unit being viewed in **SPLIT** mode is lost.

Light sensor icon	• On when the parent unit is connected to AC power, or the battery is charging. • Flashes when the parent unit battery is low and needs charging. • Off when the parent unit is disconnected from AC power.
Speaker icon	It turns on: • When the speaker volume of the parent unit is turned off; or • When the parent unit is in SPLIT mode; or • When the parent unit is talking to the baby unit.
TALK icon	• On when the parent unit is talking to the baby unit.

Parent unit status icons

Connection status icon	Connection status • Full signal displays when strong signal strength is detected between the baby unit and the parent unit. • Medium signal or Low signal displays when moderate or low signal strength is detected between the baby unit and the parent unit. • Link lost displays when the link between the baby unit and the parent unit is lost.
Lullaby icon	Lullaby • Displays when the baby unit being viewed is playing lullaby.
Current view status icon	Current view status • Displays the baby unit number of the baby unit that is being viewed when in SINGLE-CAM and PATROL mode. • Displays the baby unit number of the selected baby unit when in SPLIT mode.
PATROL mode icon	PATROL mode • Displays when the parent unit is in PATROL mode. • For VM342-2 only

SPLIT mode icon	SPLIT mode • Displays when the parent unit is in SPLIT mode. • For VM342-2 only
Night vision icon	Night vision • Displays when the baby unit being viewed has activated the night vision feature.
Zoom icon	Zoom • Displays when the current image on the parent unit has zoomed in.
Temperature alert tone icon	Temperature alert tone • Displays when the temperature alert tone is set on.
Real-time temperature icon	Real-time temperature • Displays the real-time temperature detected by the baby unit in Fahrenheit (°F) or Celsius (°C) (e.g. 57 °F or 14 °C).
Mute alert icon	Mute alert • Displays when the parent unit speaker volume is set to off. • Displays when SPLIT mode is turned on.
9-level sound indicator icon	9-level sound indicator • 1 to 3 bars indicates low sound level detected by the baby unit. • 4 to 6 bars indicates moderate sound level detected by the baby unit. • 7 to 9 bars indicates high sound level detected by the baby unit (e.g. baby crying loudly).
Speaker volume icon	Speaker volume • Displays the parent unit speaker volume level while adjusting.
Battery status icon	Battery status • Animating battery icon animates when the battery is charging. • Solid battery icon displays solid when the battery is fully charged. • Low battery icon displays when the battery is low and needs charging.
AC power without battery icon	AC power without battery • Displays when the parent unit is connected to AC power without the battery.

Parent unit main menu icons

Alert Tone icon	Alert Tone You can set the parent unit to beep when • the parent unit operates in low battery condition; • the link between the parent unit and the baby unit is lost; or • the baby unit detects sounds while in SPLIT mode.
Language icon	Language You can select a language (English, French or Spanish) to be used in all screen displays.
LCD icon	LCD You can change the brightness of the parent unit screen, or turn on the Dim Mode to save power.
Pair/Unpair CAM icon	Pair/Unpair CAM The baby unit and parent unit provided are already paired.
Rename icon	Rename You can choose a specific name for the baby unit from a pre-defined name list.
Sensitivity icon	Sensitivity With this feature, you can choose to hear sounds from the baby unit all the time, or to hear sounds that exceed a certain level. You can use the parent unit to adjust the microphone sensitivity of your baby unit. The higher the sensitivity level, the more sensitive the baby unit is in detecting sounds for transmitting to the parent unit.
Sound-activated Screen icon	Sound-activated Screen When the baby unit detects no sound, the parent unit screen stays off to save power. Once a sound is detected, the parent unit screen turns on automatically. It will then turn off again after 50 seconds of no sound detection.

Temperature icon	Temperature You can choose to set the maximum/ minimum temperature and turn on the Temperature alert tone , so that the parent unit beeps whenever the room temperature detected by the baby unit falls outside of the desired temperature range. You can choose to display the temperature in Fahrenheit (°F) or Celsius (°C) on your parent unit.
Vibration icon	Vibration You can turn on the vibration alert so that the parent unit vibrates when it receives No link alert , Sound alert in split-view or Temperature alert tone after turning on the respective alert tones.

Using the baby monitor

Power on or off the baby unit

- Slide **ON/OFF** switch upward to turn on the baby unit. The **ON/OFF** LED light turns on.
- Slide **ON/OFF** switch downward to turn off the baby unit. The **ON/OFF** LED light turns off.

Power on or off the parent unit

- Press and hold **ON** to turn on the parent unit. The screen turns on.
- Press and hold **OFF** again to turn off the parent unit. The screen turns off.

Turn on or off the parent unit screen

You can turn on or off the parent unit screen without powering off the parent unit. You can still hear sound from the baby units.

- Press and hold **LCD ON/OFF** on the parent unit to turn off the screen.
- Press any keys on the parent unit to turn on the screen again.

Adjust speaker volume

To adjust parent unit speaker volume:

- Press **vol** or **vol** on the parent unit at any time when viewing images.

NOTE

- When the parent unit speaker volume is set to zero, **0** appears on the screen and the **speaker** light turns on.

To adjust baby unit speaker volume:

- The baby unit speaker volume determines the lullaby volume and talkback volume transmitted from parent unit.
- Press **+ VOLUME -** on the baby unit to adjust the speaker volume.

Play lullaby on the baby unit

The baby monitor has five lullabies and four soothing sounds for you to comfort your baby.

To play lullaby or soothing sound on the baby unit:

You can play lullaby or soothing sound on the baby unit. You can also control the volume level.

- Press **Play/Stop** on the baby unit to play lullaby.
- Press **Next** on the baby unit to play the next lullaby.
- Press **Play/Stop** again to stop the lullaby.
- Press **+ VOLUME -** to adjust the volume level of the lullaby on the baby unit.

TIP

- When the lullaby stops, press **Play/Stop** again to replay.

Set the language

You can select a language (English, French or Spanish) to be used in all screen displays.

1. Press **MENU** when the parent unit is idle.
2. Press **Play/Stop** or **Next** to choose **Language**, then press **SELECT**.
3. Press **Play/Stop** or **Next** to choose **English**, **Français** or **Español**, then press **SELECT** to confirm your selection.

Adjust LCD brightness

You can change the brightness of the parent unit screen from **Level 1** to **Level 5**. The LCD brightness is preset to **Level 3**.

1. Press **MENU** when the parent unit is idle.
2. Press **Play/Stop** or **Next** to choose **LCD**, then press **SELECT**.
3. Press **SELECT** again to choose **Brightness**.
4. Press **Play/Stop** or **Next** to choose the desired level of brightness, then press **SELECT** to confirm your selection.

Turn on or off the dim mode

The dim mode is preset to on to help you save the parent unit power. Your parent unit display will dim automatically after 10 minutes of inactivity, in which there is neither key pressed nor alert received from the baby unit.

1. Press **MENU** when the parent unit is idle.
2. Press **Play/Stop** or **Next** to choose **Sensitivity**, then press **SELECT**.
3. Press **Play/Stop** or **Next** to choose **Dim Mode**, then press **SELECT**.
4. Press **Play/Stop** or **Next** to choose **On** or **Off**, then press **SELECT** to confirm your selection.

NOTE

- While the screen is dimmed, any keypad or alert message will trigger the screen to return to the preset brightness level. After 10 minutes of inactivity, it will be dimmed again.

Adjust the sound sensitivity of the baby unit

You can choose to hear sounds from the baby unit all the time, or to hear sounds that exceed a certain level. You can use the parent unit to adjust the microphone sensitivity of your baby unit. The higher the sensitivity level, the more sensitive the baby unit is in detecting sounds for transmitting to the parent unit. The sensitivity level is preset to **HIGHEST**.

Sensitivity Level	Description
Highest	Highest sensitivity level The parent unit speaker is constantly on, and you will hear all sounds (including background noises) from your baby's room. High sensitivity level The parent unit speaker turns on for soft babbling and louder sounds from your baby. It remains quiet when your baby sleeps soundly.
High	Medium sensitivity level The parent unit speaker turns on for loud speaking and louder sounds from your baby. It remains quiet when your baby makes soft sounds.
Medium	Low sensitivity level The parent unit speaker turns on for crying and louder sounds from your baby. It remains quiet when your baby makes soft sounds.
Low	Lowest sensitivity level The parent unit speaker turns on for loud crying or screaming sounds from your baby. It remains quiet when your baby makes soft sounds.

1. Press **MENU** when the parent unit is idle.
2. Press **Play/Stop** or **Next** to choose **Sensitivity**, then press **SELECT**.
 - If you have two baby units, the system prompts you to choose both baby units or the desired baby unit, press **Play/Stop** or **Next** to choose **ALL CAM** or **CAM #**, then press **SELECT**.
3. Press **Play/Stop** or **Next** to choose the desired sensitivity level, then press **SELECT** to confirm your selection.

TIP

- You can adjust the baby unit placement to improve the sound detection.

Turn on or off the sound activation

When sound activation is on, as long as no sound is detected within 50 seconds, the parent unit screen will turn off automatically to save power.

When your baby unit detects a sound, which exceeds the selected sensitivity level, the sound activation triggers the parent unit screen to turn on automatically. When no sound is detected within 50 seconds, the screen will be off again.

- Press **MENU** when the parent unit is idle.
- Press **▼** or **▲** to choose **Sound-activated Screen**, then press **SELECT**.
- Press **▼** or **▲** to choose **On** or **Off**, then press **SELECT** to confirm your selection. The screen returns to main menu.

NOTES

- Sound activation is available in **SINGLE-CAM** and **PATROL** mode only.
- If the sound sensitivity is set to **Highest**, the parent unit screen may remain on continuously even though sound activation is on. This depends on whether the baby unit detects any sounds.

Monitoring mode* for VM342-2 only

Every time the parent unit is turned on, it displays a baby unit in **SINGLE-CAM** mode. If there are two baby units in your system, you can also monitor your baby in **PATROL** or **SPLIT** mode.

SINGLE-CAM	The screen displays a single baby unit in full screen.
PATROL	A single cam view that transits to a different baby unit every 10 seconds.
SPLIT	The screen displays all baby units.

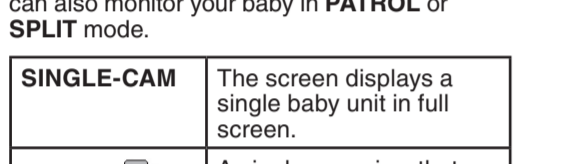

In SINGLE-CAM or PATROL mode:

- Press **VIEW** to view the next baby unit.

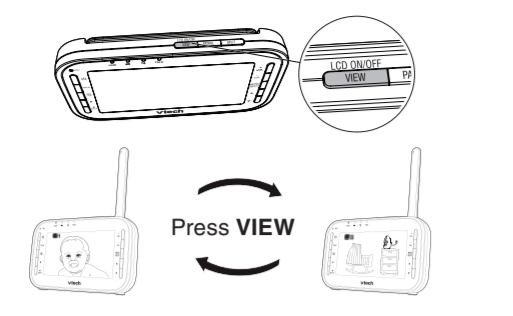

- Press **PATROL** to switch to **PATROL** mode if you are in **SINGLE-CAM** mode, and vice versa.

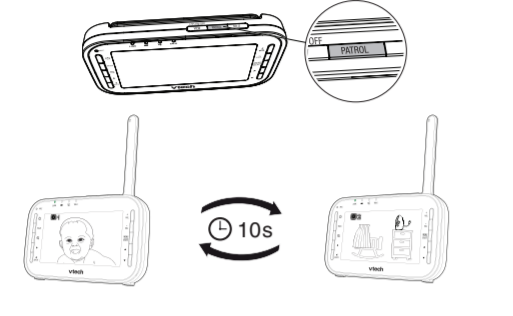

- Press **SPLIT** to enter the **SPLIT** mode.



In SPLIT mode:

- Press **▲**, **▼**, **◀** or **▶** to select a baby unit.
- Press **Q** or **VIEW** key to view the selected baby unit temporarily in **SINGLE-CAM** mode. It returns to **SPLIT** mode after 10 seconds.

NOTE

- The parent unit is muted while in **SPLIT** mode.

Zoom

You can zoom in or out while viewing image from baby unit in **SINGLE-CAM** and **PATROL** mode.

- Press **Q** to zoom in.
- Press and hold **▲** or **▼** to move the zoomed image upward or downward.
- Press and hold **◀** or **▶** to move the zoomed image leftward or rightward.
- Press **Q** again to zoom out.

Talk

You can use the **TALK** function of the parent unit to comfort your baby in **SINGLE-CAM** and **PATROL** mode.

- Press and hold **TALK** on the parent unit. The **TALK** light turns on.
- Speak towards the microphone on the parent unit. Your voice is broadcast to the baby unit.
- Release **TALK** to stop the broadcast. The **TALK** light goes off. The speaker is then turned on for around 20 seconds, so you can hear your baby.

NOTES

- The parent unit speaker is muted during voice broadcast. Sound transmission from the baby unit resumes after **TALK** is released.
- After around 20 seconds of sound re-transmission, the speaker returns to mute if you had set it to mute before pressing **TALK**.

Set alert tone

Low battery tone

You can set the parent unit to beep when the parent unit operates in low battery condition.

- Press **MENU** when the parent unit is idle.
- Press **▼** or **▲** to choose **Alert Tone**, then press **SELECT**.
- Press **SELECT** again to choose **Low Battery Tone**.
- Press **▼** or **▲** to choose **On** or **Off**, then press **SELECT** to confirm your selection.

No link alert

You can set the parent unit to beep when the link between the parent unit and the baby unit is lost.

- Press **MENU** when the parent unit is idle.
- Press **▼** or **▲** to choose **Alert Tone**, then press **SELECT**.

- Press **▼** or **▲** to choose **No Link Alert**, then press **SELECT**.
- Press **▼** or **▲** to choose **On** or **Off**, then press **SELECT** to confirm your selection.

Sound alert in split-view

You can turn on the sound alert feature so that, while in **SPLIT** mode, the parent unit beeps and displays **Sound detected at CAM #** whenever the baby unit detects sounds.

- Press **MENU** when the parent unit is idle.
- Press **▼** or **▲** to choose **Alert Tone**, then press **SELECT** to select.
- Press **▼** or **▲** to choose **Sound Alert in split-view**, then press **SELECT**.
- Press **▼** or **▲** to choose **On** or **Off**, then press **SELECT** to confirm your selection.

NOTE

- The sound alert feature is only available in **SPLIT** mode.

Monitor the temperature

Your baby unit monitors the temperature of your baby's room with its built-in temperature sensor. If the detected temperature is outside of the preset temperature range, the parent unit will display alert message.

Set temperature range

You can set the desired room temperature alert range. The minimum temperature can be set between **52 °F (11 °C)** and **69 °F (20 °C)**. The maximum temperature can be set between **70 °F (21 °C)** and **86 °F (30 °C)**.

- Press **MENU** when the parent unit is idle.
- Press **▼** or **▲** to choose **Temperature**, then press **SELECT**.
- Press **▼** or **▲** to choose **Minimum** or **Maximum**, then press **SELECT**.
 - If you have two baby units, the system prompts you to choose both baby units or the desired baby unit, press **▼** or **▲** to choose **ALL CAM** or **CAM #**, then press **SELECT**.
- Press **▼** or **▲** to choose the desired minimum or maximum temperature, then press **SELECT** to confirm your selection.

Temperature alert tone

You can turn on the temperature alert tone so that the parent unit will emit an alert tone if the detected temperature is out of range.

- Press **MENU** when the parent unit is idle.
- Press **▼** or **▲** to choose **Temperature**, then press **SELECT**.
- Press **▼** or **▲** to choose **Alert Tone**, then press **SELECT**.
 - If you have two baby units, the system prompts you to choose both baby units or the desired baby unit, press **▼** or **▲** to choose **ALL CAM** or **CAM #**, then press **SELECT**.
- Press **▼** or **▲** to choose **On** or **Off**, then press **SELECT** to confirm your selection.

Temperature format

You can choose to display the temperature in Fahrenheit (°F) or Celsius (°C).

- Press **MENU** when the parent unit is idle.
- Press **▼** or **▲** to choose **Temperature**, then press **SELECT**.
- Press **▼** or **▲** to choose **Format**, then press **SELECT**.
- Press **▼** or **▲** to choose **Fahrenheit** or **Celsius**, then press **SELECT** to confirm your selection.

Turn on or off the vibration

You can turn on the vibration feature so that the parent unit vibrates when it receives any of these alerts (after turning on the respective alert tones):

- Sound alert in split-view
- No link alert
- Temperature alert tone

- Press **MENU** when the parent unit is idle.
- Press **▼** or **▲** to choose **Vibration**, then press **SELECT**.
- Press **▼** or **▲** to choose **On** or **Off**.
- Press **SELECT** to confirm your selection.

NOTE

- If the vibration feature is turned on, the parent unit may vibrate as it receives sound broadcast from the baby unit.

Rename the baby units

You can rename each baby unit. Once the baby unit is renamed, its new name together with the baby unit number will appear in the sub-menu of below options:

- Sensitivity
- Rename
- Temperature
- Pair/Unpair CAM

- Press **MENU** when the parent unit is idle.
- Press **▼** or **▲** to choose **Rename**, then press **SELECT**.
- Press **▼** or **▲** to choose the desired baby unit, then press **SELECT**.
- Press **▼** or **▲** to choose the desired name for the baby unit, then press **SELECT** to confirm your selection.

Night vision

The baby unit has infrared LEDs that allow you to see your baby clearly at night or in a dark room. When the baby unit being viewed detects low light levels, the infrared LEDs are switched on automatically. The image from this baby unit is in black and white, and  appears on screen.

NOTES

- It is normal if you see a short white glare on your parent unit screen as the baby unit is adapting to the dark environment.
- When the infrared LEDs are on, the images are in black and white. This is normal.

TIP

- Depending on the surroundings and other interfering factors, like lightings, objects, colors and backgrounds, the display resolution may vary. Adjust the baby unit's angle or place the baby unit at a higher level to prevent glare and blurry display.

Mount the baby unit (optional)

Your baby monitor comes ready for tabletop use. You can also choose to mount your baby unit on the wall. See **Mount the baby unit (optional)** in the Quick Start Guide for the wall mounting instructions.

General product care

To keep this product working well and looking good, follow these guidelines:

- Avoid putting it near heating appliances and devices that generate electrical noise (for example, motors or fluorescent lamps).
- DO NOT** expose it to direct sunlight or moisture.
- Avoid dropping the product or treating it roughly.
- Clean with a soft cloth.
- DO NOT** immerse the parent unit and the baby unit in water and do not clean them under the tap.
- DO NOT** use cleaning spray or liquid cleaners.
- Make sure the baby unit and parent unit are dry before you connect them to the mains again.

Storage

When you are not going to use the baby monitor for some time, remove the rechargeable battery from the parent unit. Store the parent unit, the baby unit and the adapters in a cool and dry place.

Frequently asked questions

Below are the questions most frequently asked about the baby monitor. If you cannot find the answer to your question, visit our website at www.vtechphones.com, or contact 1 (800) 595-9511 for customer service.

Why does the baby monitor not respond normally?	Try the following (in the order listed) for common cure: <ol style="list-style-type: none">Disconnect the power to the baby units and the parent unit. Remove the batteries in the parent unit. Then, install the batteries again. Wait a few seconds before connecting power back to the baby units and the parent unit. Turn on the baby units and the parent unit. Wait for the parent unit to synchronize with the baby units. Allow up to one minute for this to take place.
Why don't the power-on light of the baby unit and parent unit go on when I switch on the units?	Perhaps the parent unit is not connected to the mains. Insert the appliance plug into the parent unit and put the adapter in a wall socket. Then, press and hold POWER to switch on the parent unit and to establish connection with the baby unit.
Why can't I establish a connection? Why is the connection lost every now and then? Why are there sound interruptions?	Perhaps the baby unit is not connected to the mains. Connect the baby unit to the mains. Then, set the ON/OFF switch to ON to switch on the baby unit and to establish connection with the parent unit.

Why doesn't my parent unit charge while connected to AC power?	Make sure the power is not controlled by a wall switch. <p>Make sure the battery is correctly installed in your parent unit.</p> <p>You may have used the battery for a long time. Replace a new battery.</p>
Why is my screen in black and white?	The screen is in black and white during nighttime or in a dark room. This is normal.
Why do I get glare or blurry display on my screen when viewing my baby at night?	During nighttime or in a dark room, the surroundings and other interfering factors, like lightings, objects, colors and backgrounds may affect the image quality on your parent unit screen. Adjust the baby unit's angle or place the baby unit at a higher level to prevent glare and blurry display.
Why does the baby monitor produce a high-pitched noise?	The parent unit and baby units may be too close to each other. <ul style="list-style-type: none">Move the parent unit away from the baby units until the noise stops; OR Turn down the volume of your parent unit.
The ON/OFF light on the baby unit flashes and the parent unit displays  in main menu.	Follow below steps to pair the baby unit. Make sure both parent unit and baby unit are on before pairing. <ol style="list-style-type: none">Press MENU when the parent unit is idle. Press ▼ or ▲ to choose Pair/Unpair CAM, then press SELECT. Press SELECT again to choose Pair CAM. Press ▼ or ▲ to choose an empty baby unit slot, then press SELECT. The parent unit screen displays Press and hold the pair button at the ON/OFF light for 2 seconds until the power indicator flashes. Immediately press and hold PAIR on the bottom of the baby unit with a narrow pointed object such as a pencil. The LED light flashes quickly. <p>When pairing is successful, the screen displays the view of newly paired baby unit in SINGLE-CAM mode. The LED light on the baby unit remains on.</p> <ul style="list-style-type: none">If pairing fails, the screen displays Pairing failed. Try the pairing process again. Only one baby unit can be paired at a time.
I have accidentally unpaired my baby unit.	The baby unit does not pick up soft sounds if the sensitivity level is set to a lower level. Adjust the sensitivity level to Highest to hear all sounds from your baby's room. See Adjust the sound sensitivity of the baby unit to set to a higher level.
Why can't I establish a connection? Why is the connection lost every now and then? Why are there sound interruptions?	The baby units may be out of range. Move the parent unit closer to the baby units (observe the minimum distance of 3 feet/ 1 meter).
	Other electronic products may cause interference with your baby monitor. Try installing your baby monitor as far away from these electronic devices as possible.

Why does the parent unit beep?	The baby units may be out of range. Move the parent unit closer to the baby units (but not less than 3 feet).
	If the parent unit is powered by the provided battery, it may not have enough charge for the parent unit to perform normally. Charge the battery in the parent unit for up to 3 hours.
	If your parent unit is in SPLIT mode, some of your baby units may detect sounds.
	The temperature of your baby's room may be too high or too low.
Why does the parent unit beep/vibrate frequently in SPLIT mode?	You may have set the sound sensitivity level to Highest when the sound alert (and vibration) feature is turned on. The parent unit notifies you of all sounds including background noise with beeps (and vibrations). Adjust the sound sensitivity to a lower level.
Why does the parent unit react too quickly to other sounds?	The baby unit also picks up other sounds than those of your baby. Adjust the sensitivity level to a lower level or lower the parent unit speaker volume.
Why don't I hear a sound/ Why can't I hear my baby cry?	The parent unit speaker volume may be too low or off. Press  to increase the volume.
	You may have set a low sound sensitivity level. See Adjust the sound sensitivity of the baby unit to set to a higher level.
Why does the sound from my baby monitor become intermittent or even drop out?	The baby unit does not pick up soft sounds if the sensitivity level is set to a lower level. Adjust the sensitivity level to Highest to hear all sounds from your baby's room. See Adjust the sound sensitivity of the baby unit to set to a higher level.
Why can't I establish a connection? Why is the connection lost every now and then? Why are there sound interruptions?	The baby units may be out of range. Move the parent unit closer to the baby units (observe the minimum distance of 3 feet/ 1 meter).
	Other electronic products may cause interference with your baby monitor. Try installing your baby monitor as far away from these electronic devices as possible.

Important safety instructions

When using your equipment, basic safety precautions should always be followed to reduce the risk of fire, electric shock and injury, including the following:

- Follow all warnings and instructions marked on the product.
- Adult set up is required.
- This product is intended as an aid. It is not a substitute for responsible and proper adult supervision and should not be used as such.
- This product is not intended for use as a medical monitor.
- Do not use this product near water. For example, do not use it next to a bath tub, wash bowl, kitchen sink, laundry tub or swimming pool, or in a wet basement or shower.
- CAUTION:** Use only the batteries indicated in this manual. There may be a risk of explosion if a wrong type of battery is used for the parent unit. Use only the supplied rechargeable battery or replacement battery pack (BT198555/ BT298555) for the parent unit. Do not dispose of batteries in a fire. They may explode. Dispose of used battery according to the information in The RBRC® seal.
- Use only the adapters included with this product. Incorrect adapter polarity or voltage can seriously damage the product. Baby unit power adapter: Output: 6V DC 600mA Parent unit power adapter: Output: 5V DC 1A.
- The power adapters are intended to be correctly oriented in a vertical or floor mount position. The prongs are not designed to hold the plug in place if it is plugged into a ceiling, under-the-table or cabinet outlet.
- For pluggable equipment, the socket-outlet shall be installed near the equipment and shall be easily accessible.
- Unplug this product from the wall outlet before cleaning. Do not use liquid or aerosol cleaners. Use a damp cloth for cleaning.
- Unplug the power cords before replacing batteries.
- Do not cut off the power adapters to replace them with other plugs, as this causes a hazardous situation.
- Do not allow anything to rest on the power cords. Do not install this product where the cords may be walked on or tripped.
- This product should be operated only from the type of power source indicated on the marking label. If you are not sure of the type of power supply in your home, consult your dealer or local power company.
- Do not overload wall outlets or use an extension cord.
- Do not place this product on an unstable table, shelf, stand or other unstable surface.

Technical specifications

Frequency control	Crystal controlled PLL synthesizer
Transmit frequency	Baby unit: 2405 - 2475 MHz <p>Parent unit: 2405 - 2475 MHz</p>
Channels	32
LCD	4.3" Color LCD (WOVGA 480 x 272 pixel)
Nominal effective range	Maximum power allowed by FCC. Actual operating range may vary according to environmental conditions at the time of use.
Power requirements	Parent unit: 3.7V Li-polymer battery <p>Baby unit power adapter: Output: 6V DC @ 600mA</p> <p>Parent unit power adapter: Output: 5V DC @ 1A</p>

Credits:

The *Background Noise* sound file was created by Caroline Ford, and is used under the Creative Commons license.

The *Stream Noise* sound file was created by Caroline Ford, and is used under the Creative Commons license.

The *Crickets At Night* sound file was created by Mike Koenig, and is used under the Creative Commons license.

The *Heard Beats* sound file was created by Zarabadeu, and is used under the Creative Commons license.

repair activity. You must pay for the cost of repair and return shipping costs for the repair products that are not covered by this limited warranty.

What must you return with the Product to get warranty service?

- Return the entire original package and contents including the Product to the VTech service location along with a description of the malfunction or difficulty; and
- Include a "valid proof of purchase" (sales receipt) identifying the Product purchased (Product model) and the date of purchase or receipt; and
- Provide your name, complete and correct mailing address, and telephone number.

Other limitations

This warranty is the complete and exclusive agreement between you and VTech. It supersedes all other written or oral communications related to this Product. VTech provides no other warranties for this Product. The warranty exclusively describes all of VTech's responsibilities regarding the Product. There are no other express warranties. No one is authorized to make modifications to this limited warranty and you should not rely on any such modification.

State/Provincial Law Rights: This warranty gives you specific legal rights, and you may also have other rights, which vary from state to state or province to province.

Limitations: Implied warranties, including those of fitness for a particular purpose and merchantability (an unwritten warranty that the Product is fit for ordinary use) are limited to one year from the date of purchase. Some states/provinces do not allow limitations on how long an implied warranty lasts, so the above limitation may not apply to you. In no event shall VTech be liable for any indirect, special, incidental, consequential, or similar damages (including, but not limited to lost profits or revenue, inability to use the Product or other associated equipment, the cost of substitute equipment, and claims by third parties) resulting from the use of this Product. Some states/provinces do not allow the exclusion or limitation of incidental or consequential damages, so the above limitation or exclusion may not apply to you.

Please retain your original sales receipt as proof of purchase.

the repaired or replacement Products to you in person. Repairs should be completed, repaired or replacement to take approximately 30 days.

How long is the limited warranty period?

The limited warranty period for the Product extends for ONE (1) YEAR from the date of purchase. If VTech repairs or replaces a Materially Defective Product under the terms of this limited warranty, the limited warranty period applies to the repaired or replacement Product for a period of either (a) 90 days from the date the repaired or replacement Product is shipped to you or (b) the time remaining on the original one-year warranty; whichever is longer.

What is not covered by this limited warranty?

This limited warranty does not cover:

- Product that has been subjected to misuse, accident, shipping or other physical damage, improper installation, abnormal operation or handling, neglect, inundation, fire, water or other liquid intrusion; or
- Product that has been damaged due to repair, alteration or modification by anyone other than an authorized service representative of VTech; or
- Product to the extent that the problem experienced is caused by signal conditions, network reliability, or cable or antenna systems; or
- Product to the extent that the problem is caused by use with non-VTech accessories; or
- Product whose warranty/quality stickers, product serial number, date of purchase or electronic serial numbers have been removed, altered or rendered illegible; or
- Product purchased, used, serviced, or shipped for repair from outside the United States of America or Canada, or used for commercial or institutional purposes (including but not limited to Products used for rental purposes); or
- Product returned without a valid proof of purchase (see item 2 below); or
- Charges for installation or set up, adjustment of customer controls, and installation or repair of systems outside the unit.

How do you get warranty service?

To obtain warranty service, please visit our website at www.vtechphones.com or call 1 (800) 595-9511. NOTE: Before calling for service, please review the user's manual - a check of the Product's controls and features may save you a service call.

Except as provided by applicable law, you assume the risk of loss or damage during transit and transportation and are responsible for delivery or handling charges incurred in the transport of the Product(s) to the service location. VTech will return repaired or replaced Product under this limited warranty. Transportation, delivery or handling charges are prepaid. VTech assumes no risk for damage or loss of the Product in transit. If the Product failure is not covered by this limited warranty, or proof of purchase does not meet the terms of this limited warranty, VTech will notify you and will request that you authorize the cost of repair prior to any further

This product meets the applicable Innovation, Science and Economic Development Canada technical specifications.

RF radiation exposure statement

The baby unit complies with FCC RF radiation exposure limits set forth for an uncontrolled environment. The baby unit should be installed and operated with a minimum distance of 8 in (20 cm) between the baby unit and all persons' body. Use of other accessories may not ensure compliance with FCC RF exposure guidelines. This transmitter must not be co-located or operating in conjunction with any other antenna or transmitter. This equipment complies also with Industry Canada RSS-102 with respect to Canada's Health Code 6 for Exposure of Humans to RF Fields.

California Energy Commission battery charging testing mode

This baby monitor meets the California Energy Commission (CEC) regulations for energy consumption. Your baby monitor is set up to comply with the energy-conserving standards right out of the box.

Follow the instructions to install and charge the battery. The CEC battery charging testing mode is activated while charging.

Even if the parent unit is paired to baby units, the CEC battery charging testing mode is activated while it is powered off and charging.

For cETL compliance only

Mesures de sécurité importantes

Lorsque vous utilisez votre appareil, vous devriez toujours suivre certaines mesures de précaution de base afin de réduire les risques d'incendie, d'électrocution et de blessures corporelles, dont ceux qui suivent :

- Observez toutes les instructions et mises en garde inscrites sur l'appareil.
- L'installation par un adulte est requise.
- Ce produit a été conçu pour être un dispositif d'appoint seulement. Il n'est pas le remplacement d'une supervision responsable et adéquate par un adulte et ne devrait pas être utilisé comme telle.
- Ce produit n'est pas conçu pour être utilisé en tant que moniteur médical.
- N'utilisez pas cet appareil près de l'eau ni de toute autre source d'humidité, par exemple, près d'une baignoire, cuve à lessive, évier de cuisine, dans un sous-sol humide ni près d'une piscine, dans un sous-sol humide ou une douche.
- MISE EN GARDE**: Il peut y avoir un risque d'explosion si vous utilisez le mauvais type de piles pour l'unité du parent. N'utilisez que le

bloc-piles rechargeable inclus ou le bloc-piles de secours (BT1198555/ BT298555). N'incendiez pas les piles. Celles-ci risqueraient d'exploser. Jetez les piles usées selon les renseignements suivant le sceau du RBRC®.

- N'utilisez que les adaptateurs inclus avec ce produit. L'utilisation d'un adaptateur dont la polarité ou la