

Go to www.vtechphones.com to register your product for enhanced warranty support and the latest VTech product news.



vttech®

Quick start guide

For more support information

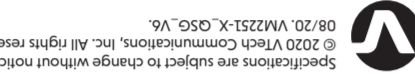

© 2020 VTech Communications, Inc. All rights reserved.
 08/20 VM2251-K_0350_VA
 Specifications are subject to change without notice.
 The *Heart Beat* sound file was created by Karabaden, and is used under the Creative Commons license.
 The *Crickets At Night* sound file was created by Mike Kenney, and is used under the Creative Commons license.
 The *Stream Noise* sound file was created by Caroline Ford, and is used under the Creative Commons license.
 The *Background noise* sound file was created by Caroline Ford, and is used under the Creative Commons license.

TECHNICAL SPECIFICATIONS	
Frequency control	Crystal controlled PLL synthesizer
Transmit frequency	Baby unit: 2407.5 - 2475 MHz Parent unit: 2407.5 - 2475 MHz
Channels	21
LCD	2.4" Color LCD (QVGA 320x240 pixel)
Nominal effective range	May vary according to environmental conditions at the time of use.
Power requirements	1. Parent unit and baby unit power adapters: Output: 6V DC @ 400mA Model: VT05EUS0506040 (V-Tech) 2. Parent unit: 4.8V Ni-MH battery Model: NI-MH AA800MAH 3.6V (Cornu)
Credits:	

IMPORTANT SAFETY INSTRUCTIONS

- The applied nameplate is located at the bottom of the baby unit's base.
- When using your equipment, basic safety precautions should always be followed to reduce the risk of fire, electric shock and injury, including the following:
- Follow all warnings and instructions marked on the product.
 - Adult setup is required.
 - CAUTION:** Do not install the baby unit at a height above 2 meters.
 - This product is not a substitute for adult supervision of the infant. Supervising the infant is the parent's or caregiver's responsibility. This product could cease operating, and therefore you should not assume it will continue working properly for any given period of time. Further, this is not a medical device and should not be used as such. This product is intended to assist you in supervising your baby. Do not use this product near water. For example, do not use it next to a bath tub, wash bowl, kitchen sink, laundry tub or swimming pool, or in a wet basement or shower.
 - CAUTION:** Use only the battery provided. There may be a risk of explosion if a wrong type of battery is used for the parent unit. The battery cannot be subjected to high or low extreme temperature and low air pressure at high altitude during use, storage or transportation. Disposal of battery into fire or a hot oven, or mechanically crushing or cutting or the battery can result in an explosion. Leaving the battery in an extremely high temperature surrounding environment can result in an explosion or the leakage of flammable liquid or gas. Battery subjected to extremely low air pressure may result in an explosion or the leakage of flammable liquid or gas. Dispose of used battery according to the information in **The RBRIC seal**.
 - Use only the adapters included with this product. Incorrect adapter polarity or voltage can seriously damage the product.
Baby unit power adapter: Output: 6V DC 400mA;
Parent unit power adapter: Output: 6V DC 400mA.
 - The power adapters are intended to be correctly oriented in a vertical or floor mount position. The prongs are not designed to hold the plug in place if it is plugged into a ceiling, under-the-table or cabinet outlet.
 - For pluggable equipment, the socket-outlet shall be installed near the equipment and shall be easily accessible.
 - Unplug this product from the wall outlet before cleaning. Do not use liquid or aerosol cleaners. Use a damp cloth for cleaning.
 - Do not cut out off the power adapters to replace them with other plugs, as this causes a hazardous situation.
 - Do not allow anything to rest on the power cords. Do not install this product where the cords may be walked on or crimped.
 - This product should be operated only from the type of power source indicated on the marking label. If you are not sure of the type of power supply available at your home, consult your dealer or local power company.
 - Do not overload wall outlets or use an extension cord.
 - Do not place this product on an unstable table, shelf, stand or other unstable surface.
 - This product should not be placed in any area where proper ventilation is not provided. Slots and openings in the back or bottom of this product are provided for ventilation. To protect them from overheating, these openings must not be blocked by placing the product on a soft surface such as a bed, sofa or rug. This product should never be placed near or over a radiator or heat register.
 - Never push objects of any kind into this product through the slots because they may touch dangerous voltage points or create a short circuit. Never spill liquid of any kind on the product.

WHAT'S IN THE BOX

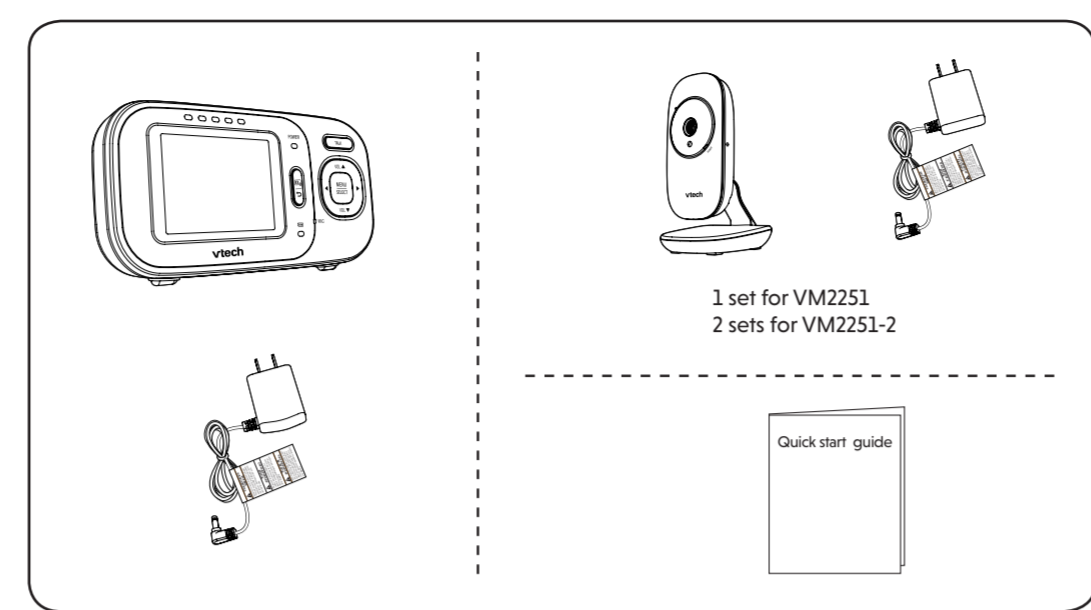

1 CONNECT THE BABY MONITOR

Connect the baby monitor

NOTES

- The rechargeable battery is pre-installed in your parent unit.
- Use only the power adapters supplied with this product.
- Make sure the baby monitor is not connected to the switch controlled electric outlet.
- Connect the power adapters in a vertical or floor mount position only. The adapters' prongs are not designed to hold the weight of baby monitor, so do not connect them to any ceiling, under-the-table, or cabinet outlets. Otherwise, the adapters may not properly connect to the outlets.
- Make sure the parent unit, the baby unit and the power adapter cords are out of reach of children.

Precautions for users of implanted cardiac pacemakers
 Cardiac pacemakers (applies only to digital cordless devices):
 Wireless Technology Research, LLC (WTR), an independent research entity, led a multidisciplinary evaluation of the interference between portable wireless devices and implanted cardiac pacemakers. Supported by the U.S. Food and Drug Administration, WTR recommends to physicians that:
Pacemaker patients
 • Should keep wireless devices at least six inches from the pacemaker.
 • Should NOT place wireless devices directly over the pacemaker, such as in a breast pocket, when it is turned ON.
 WTR's evaluation did not identify any risk to bystanders with pacemakers from other persons using wireless devices.

Electromagnetic fields (EMF)
 This VTech product complies with all standards regarding electromagnetic fields (EMF). If handled properly and according to the instructions in this user's manual, the product is safe to be used based on scientific evidence available today.

1 CONNECT THE BABY MONITOR (CONT'D)

Charge the parent unit battery

When you have connected and turned on the parent unit, the battery will be charged automatically.

NOTES

- Before using the baby monitor for the first time, charge the parent unit battery for 12 hours. When the parent unit battery is fully charged, the battery icon becomes solid .
- It takes longer to charge the battery when the parent unit is turned on. To shorten the charging time, turn the parent unit off while charging.
- The standby time varies depending on the sensitivity level you set, your actual use and the age of the battery.

BATTERY INDICATORS	BATTERY STATUS	ACTION
The screen displays Battery low at Parent Unit. or .	The battery has very little charge and may be used for only a short time.	Charge without interruption (about 30 minutes).
The battery icon becomes solid .	The battery is fully charged.	To keep the battery charged, connect it to AC power when not in use.

2 POWER ON OR OFF THE BABY MONITOR

- Slide the **ON/OFF** switch to power on or off your baby unit.
- Press and hold to power on or off your parent unit.

3 POSITIONING THE BABY MONITOR

- Position the baby unit at least 3ft (1m) away from the parent unit.
- Position the baby unit at least 3ft (1m) away from the parent unit.
- Position the baby unit at least 3ft (1m) away from the parent unit.
- Position the baby unit at least 3ft (1m) away from the parent unit.

CAUTION

- The default volume of your parent unit is level 3, and the maximum volume is level 5. If you experience high-pitched screeching noise from your baby monitor while positioning:
 - Make sure your baby unit and parent unit are more than 1 meter (3 feet) apart, OR
 - Turn down the volume of your parent unit.

NOTE

- To avoid interference from other electronic devices, place your baby monitor at least 3 feet (1 meter) away from devices such as wireless routers, microwaves, cell phones and computers.

4 STATUS CHECK

Once you power on both your baby unit and parent unit, your parent unit displays image from the baby unit, and the connection status displays on the LCD screen.

The **POWER** LED light of baby unit turns on.

BASIC OPERATION - PARENT UNIT

Adjust speaker volume

Press **VOL▲** / **VOL▼** to adjust your parent unit speaker volume.

The sound sensitivity setting also affects the speaker volume. For details, refer to **Sound sensitivity and sound activation**.

Set screen off timer

- Press **MENU** to enter the main menu when the parent unit is idle.
- Press **◀** or **▶** to choose , then press **SELECT** or **▲** to open the submenu.
- Press **▲** or **▼** to choose the desired time period to automatically turn off screen (**OFF** / - 5 min. / - 30 min. / - 60min.), then press **MENU** to confirm your selection.

TIP

- Press any keys on the parent unit to turn on the screen again.

Talk to your baby unit

Press and hold **TALK** and speak to your parent unit. Your voice is transmitted to the baby unit.

LCD off

Press to turn off LCD and keep the sound broadcast.

OVERVIEW - BABY UNIT

Use the menu

Press **MENU** to enter the menu, choose a menu item, or save a setting. You can use the parent unit for advanced settings or operations, such as to adjust the baby unit sound sensitivity or the temperature range for alerts.

While in the menu:

- Press **◀** or **▶** to scroll among the main menu options.
- Press **MENU** to choose a submenu item, or save a setting.
- Press **▲** or **▼** to scroll among the submenu options.
- Press **▶** to exit the main menu or submenu.

Main menu

Submenu

OVERVIEW - PARENT UNIT

- Visual sound indicators
- LCD off / Back
- LCD display
- ON/OFF switch
- POWER LED light
- TALK
- MENU/SELECT
- Arrow keys and VOL▲ / VOL▼
- Microphone
- Battery indicator
- Speaker
- Stand
- Power jack

OVERVIEW - PARENT UNIT

- Microphone
- Infrared LEDs
- Camera
- Light sensor
- POWER LED light
- Speaker
- Power jack
- ON/OFF switch
- Wall mount holes

NEED HELP?

For operations and guides to help you using your video monitor, and for latest information and supports, go and check the online help topics and online FAQs.

Use your smartphone or mobile device to access our online help.

- Go to <https://help.vtechphones.com/vm2251> or <https://help.vtechphones.com/vm2251-2>; OR
- Scan the QR code on the right. Launch the camera app or QR code scanner app on your smartphone or tablet. Hold the device's camera up to the QR code and frame it. Tap the notification to trigger the redirection of the online help.
- If the QR code is not clearly displayed, adjust your camera's focus by moving your device closer or further away until it is clear.

You can also call our Customer Support at 1 (800) 595-9511 [in US] or 1 (800) 267-7377 [in Canada] for help.

PARENT UNIT ICONS

Main menu icons

Status icons

- Connection status**
 - displays when strong signal strength is detected between the baby unit and the parent unit.
 - or displays when moderate or low signal strength is detected between the baby unit and the parent unit.
 - displays when the link between the baby unit and the parent unit is lost.
- Patrol mode**
 - Displays when the parent unit is in **PATROL** mode.
 - For VM2251-2 only.
- Current view status**
 - Displays the number of the baby unit that is being viewed.
- Lullaby**
 - Displays when a lullaby is playing.
- Zoom**
 - Displays when the current image on the parent unit has zoomed in.
- Night vision**
 - Displays when the baby unit being viewed has activated the night vision feature.
- Mute alert**
 - Displays when the parent unit speaker is turned off.
 - Displays when the parent unit is talking to the baby unit.
- Real-time temperature**
 - Displays the real-time temperature detected by the baby unit in Fahrenheit (°F) or Celsius (°C) (e.g. **57°F** or **14°C**).
- Battery status**
 - animates when the battery is charging.
 - displays solid when the battery is fully charged.
 - displays when the battery is low and needs charging.
- Speaker volume**
 - Displays the parent unit speaker volume level while adjusting.

Main menu icons

- Monitoring mode**
 - You can enter the monitoring mode to view the video from the baby unit.
 - For VM2251-2 only.
- Zoom**
 - You can zoom in or out with 1x, 2x options while viewing image.
- Lullaby**
 - You can select, play, or stop a lullaby.
- Brightness**
 - You can change the brightness of the parent unit screen.
- LCD screen off timer**
 - You can set a specific time to turn the screen off.
- VOX sensitivity**
 - With this feature, you can choose to hear sounds from the baby unit all the time, or to hear sounds that exceed a certain level. You can use the parent unit to adjust the microphone sensitivity of your baby unit. The higher the sensitivity level, the more sensitive the baby unit is in detecting sounds for transmitting to the parent unit.

Warning icons and messages

- /No Link to Camera**
 - The selected baby unit is out of range or is turned off.
- /Battery low at Parent Unit**
 - The battery is empty and needs to be recharged.
- /Temperature too high or /Temperature too low**
 - The temperature detected by the baby unit is higher/lower than the desired temperature alert range.
- Searching for baby units**
 - The parent unit is searching for baby units.
- Connected to AC power**
 - The parent unit is connected to AC power.
- Sound-activated screen**
 - When the baby unit detects no sound, the parent unit screen stays off to save power. Once a sound is detected, the parent unit screen turns on automatically. It will then turn off again after 50 seconds of no sound detection.
- Temperature alert**
 - You can turn on the temperature alert tone so that the parent unit beeps whenever the room temperature detected by the baby unit falls outside of the desired temperature range. You can choose in Fahrenheit (°F) or Celsius (°C) as the temperature format displayed, or set the maximum/minimum temperature limit for alerts.

