

Go to www.vtechphones.com (US) to register your product for enhanced warranty support and latest Vtech product news.

Go to phones.vtechcanada.com (CA) for latest Vtech product news.

VG208
VG208-2

DECT 6.0 corded/cordless telephone



Scan the QR code for support information

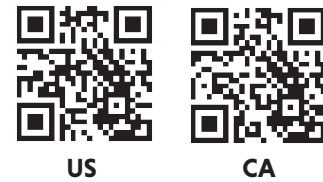

WHAT'S IN THE BOX

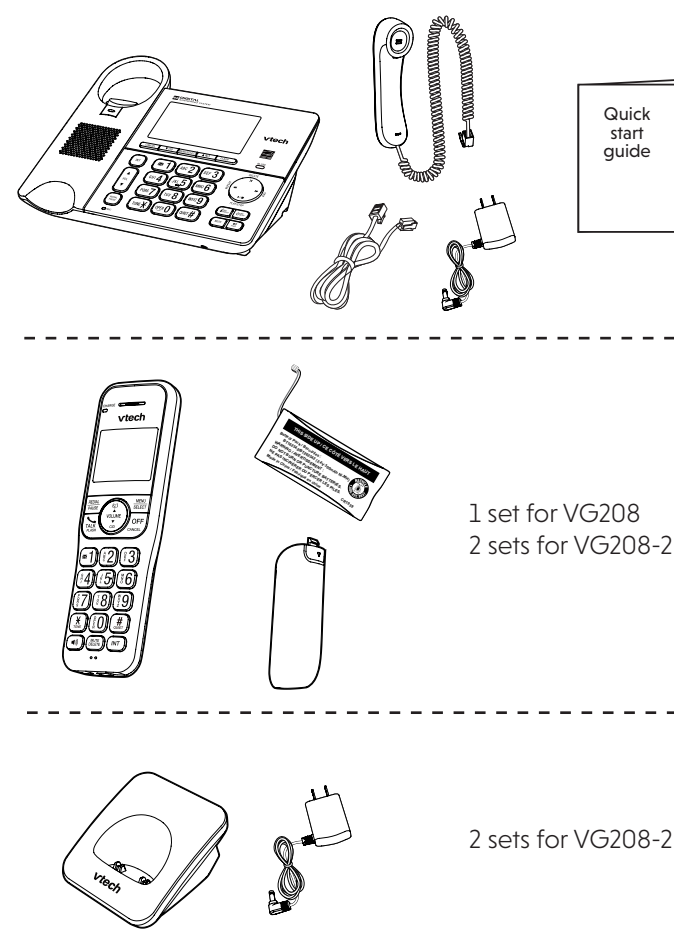

1 set for VG208
2 sets for VG208-2

2 sets for VG208-2

IMPORTANT SAFETY INSTRUCTIONS

- When using your telephone equipment, basic safety precautions should always be followed to reduce the risk of fire, electric shock and injury, including the following:
- Read and understand all instructions.
 - Follow all warnings and instructions marked on the product.
 - Unplug this product from the wall outlet before cleaning. Do not use liquid or aerosol cleaners. Use a damp cloth for cleaning.
 - CAUTION:** Do not install the telephone base at a height above 2 meters.
 - Do not use this product near water such as near a bath tub, wash bowl, kitchen sink, laundry tub or a swimming pool, nor in a wet basement or shower.
 - Do not place this product on an unstable table, shelf, stand or other unstable surfaces.
 - Avoid placing the telephone system in places with extreme temperature, direct sunlight, or other electrical devices. Protect your phone from moisture, dust, corrosive liquids and fumes.
 - Slots and openings in the back or bottom of the telephone base and handset are provided for ventilation. To protect them from overheating, these openings must not be blocked by placing the product on a soft surface such as a bed, sofa or rug. This product should never be placed near or over a radiator or heat register. This product should not be placed in any area where proper ventilation is not provided.
 - This product should be operated only from the type of power source indicated on the marking label. If you are not sure of the type of power supply in your home or office, consult your dealer or local power company.
 - Do not allow anything to rest on the power cord. Do not install this product where the cord may be walked on.
 - Never push objects of any kind into this product through the slots in the telephone base or handset because they may touch dangerous voltage points or create a short circuit. Never spill liquid of any kind on the product.
 - To reduce the risk of electric shock, do not disassemble this product, but take it to an authorized service facility. Opening or removing parts of the telephone base or handset other than specified access doors may expose you to dangerous voltages or other risks. Incorrect reassembly can cause electric shock when the product is subsequently used.
 - Do not overload wall outlets and extension cords.
 - Unplug this product from the wall outlet
- and refer servicing to an authorized service facility under the following conditions:
- When the power supply cord or plug is damaged or frayed.
 - If liquid has been spilled onto the product.
 - If the product has been exposed to rain or water.
 - If the product does not operate normally by following the operating instructions. Adjust only those controls that are covered by the operation instructions. Improper adjustment of other controls may result in damage and often requires extensive work by an authorized technician to restore the product to normal operation.
 - If the product has been dropped and the telephone base and/or handset has been damaged.
 - If the product exhibits a distinct change in performance.
- Avoid using a telephone (other than cordless) during an electrical storm. There is a remote risk of electric shock from lightning.
 - Do not use the telephone to report a gas leak in the vicinity of the leak. Under certain circumstances, a spark may be created when the adapter is plugged into the power outlet, or when the handset is replaced in its cradle. This is a common event associated with the closing of any electrical circuit. The user should not plug the phone into a power outlet, and should not put a charged handset into the cradle, if the phone is located in an environment containing concentrations of flammable or flame-supporting gases, unless there is adequate ventilation. A spark in such an environment could create a fire or explosion. Such environments might include: medical use of oxygen without adequate ventilation; industrial gases (cleaning solvents; gasoline vapors; etc.); a leak of natural gas, etc.
 - Only put the handset of your telephone next to your ear when it is in normal talk mode.
 - The power adapter is intended to be correctly oriented in a vertical or floor mount position. The prongs are not designed to hold the plug in place if it is plugged into a ceiling, under-the-table or cabinet outlet.
 - For pluggable equipment, the socket-outlet shall be installed near the equipment and shall be easily accessible.
 - CAUTION:** Use only the batteries indicated in this manual. There may be a risk of explosion if a wrong type

- of battery is used for the handset. Use only the supplied rechargeable batteries or replacement batteries (BT26242/ BT262342) for the handset. Do not dispose of batteries in a fire. They may explode.
- Do not use the battery in following conditions:
 - High or low extreme temperature during use, storage or transportation.
 - Replacement of a battery with an incorrect type that can defeat a safeguard.
 - Disposal of a battery into fire or a hot oven, or mechanically crushing or cutting of a battery, that can result in an explosion.
 - Leaving a battery in an extremely high temperature surrounding environment that can result in an explosion or the leakage of flammable liquid or gas.
 - A battery subjected to extremely low air pressure that can result in an explosion or the leakage of flammable liquid or gas.
 - Use only the adapter included with this product. Incorrect adapter polarity or voltage can seriously damage the product.
- SAVE THESE INSTRUCTIONS**
- Battery**
- CAUTION:** Use Only Supplied Battery.
 - Do not dispose of the battery in a fire. Check with local waste management codes for special disposal instructions.
 - Do not open or mutilate the battery. Released electrolyte is corrosive and may cause burns or injury to the eyes or skin. The electrolyte may be toxic if swallowed.
 - Exercise care in handling batteries in order not to create a short circuit with conductive materials.
 - Charge the battery provided with this product only in accordance with the instructions and limitations specified in this manual.
- Precautions for users of implanted cardiac pacemakers**
Cardiac pacemakers (applies only to digital cordless telephones):
Wireless Technology Research, LLC (WTR), an independent research entity, led a multidisciplinary evaluation of the interference between portable wireless telephones and implanted cardiac pacemakers. Supported by the U.S. Food and Drug Administration, WTR recommends to physicians that:
- Should keep wireless telephones at least six inches from the pacemaker.
- Should NOT** place wireless telephones directly over the pacemaker, such as in a breast pocket, when it is turned ON.
- Should use the wireless telephone at the ear opposite the pacemaker.
- WTR's evaluation did not identify any risk to bystanders with pacemakers from other persons using wireless telephones.
- About cordless telephone**
- Privacy:** The same features that make a cordless telephone convenient create some limitations. Telephone calls are transmitted between the telephone base and the cordless handset by radio waves, so there is a possibility that the cordless telephone conversations could be intercepted by radio receiving equipment within range of the cordless handset. For this reason, you should not think of cordless telephone conversations as being as private as those on corded telephones.
 - Electrical power:** The telephone base of this cordless telephone must be connected to a working electrical outlet. The electrical outlet should not be controlled by a wall switch. Calls cannot be made from the cordless handset if the telephone base is unplugged, switched off or if the electrical power is interrupted.
 - Potential TV interference:** Some cordless telephones operate at frequencies that may cause interference to televisions and VCRs. To minimize or prevent such interference, do not place the telephone base of the cordless telephone near or on top of a TV or VCR. If interference is experienced, moving the cordless telephone farther away from the TV or VCR often reduces or eliminates the interference.
 - Rechargeable batteries:** Exercise care in handling batteries in order not to create a short circuit with conducting material such as rings, bracelets and keys. The battery or conductor may overheat and cause harm. Observe proper polarity between the battery and the battery charger.
 - Nickel-metal hydride rechargeable batteries:** Dispose of these batteries in a safe manner. Do not burn or puncture the battery. Like other batteries of this type, if burned or punctured, they could release caustic material which could cause injury.

CONNECT AND ACTIVATE

1 Connect the telephone base

If you subscribe to digital subscriber line (DSL) high-speed Internet service through your telephone line, make sure you connect a DSL filter (not included) to the telephone wall jack.

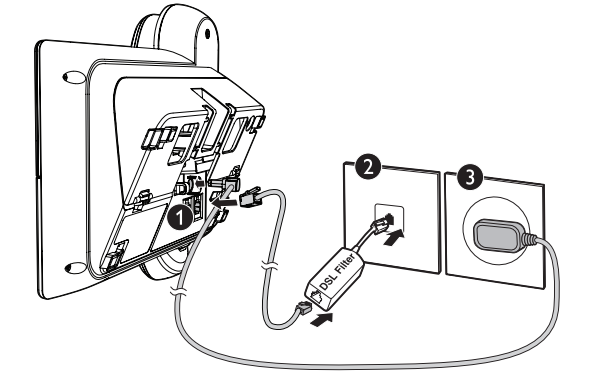

2 Install the battery

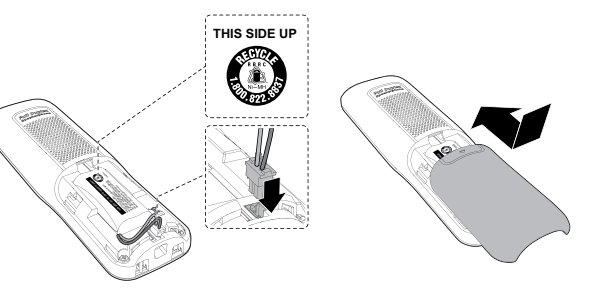

3 Connect the charger

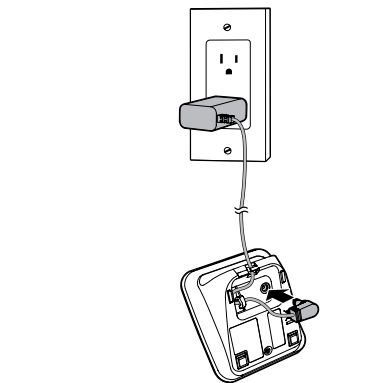

4 Charge the battery

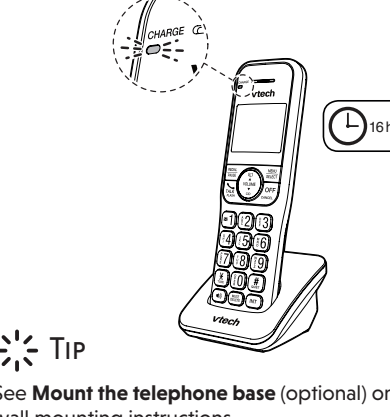

TIP
See **Mount the telephone base** (optional) online for the wall mounting instructions.

Display

Handset:



Telephone base:

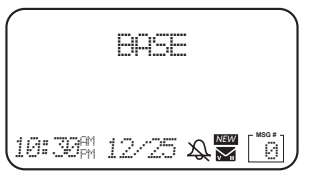

	The battery is low and needs charging.		Telephone base ringer is off.
	The battery is charging.		New voicemail received from your telephone service provider.
	The battery is fully charged.		New caller ID log entries.
	Handset ringer is off.		Telephone base message counter displays the total number of messages.
	New voicemail received from your telephone service provider.		
	There are new caller ID log entries.		
	Answering system is on.		
	Handset displays the current message number being played and the total number of new/old messages recorded.		
	The ECO mode activates automatically to reduce power consumption when the handset is within range of the telephone base.		

Specifications are subject to change without notice.
© 2021 Vtech Communications, Inc.
Address: 9020 SW Washington Square Road - Ste 555 Tigard, OR 97223, United States
Phone: 1 (800) 595-9511 in the U.S. or 1 (800) 267-7377 in Canada

DISCLAIMER AND LIMITATION OF LIABILITY
Vtech Communications, Inc. and its suppliers assume no responsibility for any damage or loss resulting from the use of this user's manual. Vtech Communications, Inc. and its suppliers assume no responsibility for any loss or claims by third parties that may arise through the use of this product.
The ENERGY STAR program (www.energystar.gov) recognizes and encourages the use of products that save energy and help protect our environment. We are proud to mark this product with the ENERGY STAR label indicating it meets the latest energy efficiency guidelines.

Frequency control	Crystal controlled PLL synthesizer
Transmit frequency	Handset: 1921.536-1928.448 MHz Telephone base: 1921.536-1928.448 MHz
Channels	DECT channel: 5
Power requirement	Handset: 2.4V Ni-MH battery Telephone base: 6V DC @ 0.4A Charger: 6V DC @ 0.4A
Memory	Phonebook: 50 memory locations; up to 30 digits and 15 characters; Caller ID log: 30 memory locations; up to 24 digits and 15 characters; Call block: 150 entries

2 SETUP

After you install your telephone or power returns following a power outage and battery depletion, the handset and telephone base will prompt you to set the date and time, and to configure the answering system through voice guide.

Date and time

Follow the steps below to set the date and time. For example, if the date is 25 August 2021, and the time is 10:59 AM:

When the handset and telephone base prompt you to set the date and time

- Enter the date.
- Press **SELECT**.
- Enter the time.
- Press **SELECT**.

Follow the following steps to set the date and time if you skipped the prompt.

- Press **MENU**.
- Press **▼/▲** to scroll to **Set date/time**, then press **SELECT**.
- Enter the date, then press **SELECT**.
- Enter the time, then press **SELECT**.

Voice guide for answering system

After setting the date and time, the handset and telephone base will display **Voice guide to...** and **set up Ans sys?** alternatively.

This feature assists you to do the basic setup of the answering system. You can follow the voice guide to record your own announcement, set the number of rings and the message alert tone.

When the handset prompts you to set up the answering system via voice guide

Press **SELECT**.

"Hello! This voice guide will assist you with the basic setup of your answering system"

Setup your answering system by inputting the designated numbers as instructed in the voice guide.

BASIC OPERATION

Make a call

Handset:

- Press **TALK FLASH** - OR -
- Enter the phone number

Telephone base:

- Press - OR - Lift the corded handset
- Enter the phone number

Answer a call

Press **Handset:** **TALK FLASH** - OR - - OR - Press any dialing keys to answer

Telephone base: - OR - Lift the corded handset

End a call

Press **Handset:** - OR -

Telephone base: - OR - Lift the corded handset

Volume

Press **Handset:**

Telephone base:

CALLER ID

Caller ID

If you subscribe to caller ID service, information about each caller appears after the first or second ring.

The caller ID log stores up to 30 entries. Each entry has up to 24 digits for the phone number and 15 characters for the name.

Review caller ID log entries

- Press **CID**.
- Press **▼/▲** to browse the entries.

Delete a caller ID log entry

Press **MUTE DELETE**.

Save a caller ID log entry to the phonebook

- Press **MENU**.
- Press **SELECT** to select **To phonebook**.

Need help?

For operations and guides to help you using your telephone system, and for latest information and supports, go and check the online help topics and online FAQs.

Use your smartphone or mobile device to access our online help.

- Go to <https://help.vtechphones.com>/VG208; OR
- Scan the QR code on the right. Launch the camera app or QR code scanner app on your smartphone or tablet. Hold the device's camera up to the QR code and frame it.

Dial a caller ID log entry

When your desired caller ID entry displays on the handset or telephone base screen

Press **Handset:** **TALK FLASH** - OR -

Telephone base: - OR - Lift the corded handset

Delete a caller ID log entry

When your desired caller ID entry displays on the handset or telephone base screen

Press **MUTE DELETE**.

Save a caller ID log entry to the phonebook

- Press **MENU**.
- Press **SELECT** to select **To phonebook**.

Edit the phone number if needed.

- Edit the phone number if needed.
- Press **SELECT**.

Edit the name if needed, then press SELECT.

- Edit the name if needed, then press **SELECT**.

Need help?

Tap the notification to trigger the redirection of the online help.

- If the QR code is not clearly displayed, adjust your camera's focus by moving your device closer or further away until it is clear.

You can also call our Customer Support at
1 (800) 595-9511 [in US] or
1 (800) 267-7377 [in Canada] for help.

LCD LANGUAGE SETTING

If you accidentally set the LCD language to Spanish or French, press **MENU** and then enter **X364#** to change the handset LCD language back to English while the handset is not in use.

PHONEBOOK

Phonebook

The phonebook can store up to 50 entries, which are shared by all handsets and the telephone base. Each entry may consist of a telephone number up to 30 digits, and a name up to 15 characters.

Add a phonebook entry



1. Press MENU. 2. Press SELECT. 3. Enter the phone number. 4. Enter the name.



5. Press SELECT.

Review phonebook entries



1. Press MENU. 2. Press SELECT to browse the entries.

Delete a phonebook entry

When your desired phonebook entry displays on the handset screen



1. Press DELETE. 2. Press SELECT.



ANSWERING SYSTEM

About the built-in answering system and voicemail service

For message recording, your telephone has a built-in answering system, and it also supports voicemail service offered by your telephone service provider (subscription is required, and fee may apply).

Built-in answering system VS Voicemail service

	BUILT-IN ANSWERING SYSTEM	VOICEMAIL SERVICE
SUPPORTED BY	Telephone system	Telephone service provider
SUBSCRIPTION	No	Yes
FEES	No	May apply
ANSWER INCOMING CALLS	• After 3 rings by default. • It can be changed via handset or the telephone base menu.	• Usually after 2 rings. • It can be changed by contacting your telephone service provider.
STORAGE	Telephone base	Server or System
DISPLAY NEW MESSAGES	• Handset - XX new messages • Telephone base - Message window flashes	• Handset - M and New voicemail • Telephone base - M
RETRIEVE MESSAGES	• Press M on the telephone base; OR • Press MENU, and then select Play messages on the handset; OR • Access remotely with an access code.	• Press M on the dialpad, and enter an access number and/or passcode from your telephone service provider.

Turn the built-in answering system on or off

On the telephone base

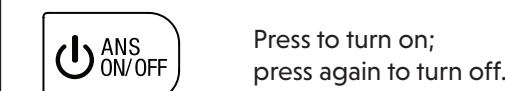

Press to turn on; press again to turn off.

Set number of rings

You can set your answering system to answer calls at least two rings earlier than your voicemail service. For example, if your voicemail service answers after six rings, set your answering system to answer after four rings. Thus, if you are on a call, or if the answering system is busy recording a message and you receive another call, the second caller can leave a voicemail message.

NOTE

You can set the answering system to answer an incoming call after 2, 3, 4, 5 or 6 rings; or Toll saver. If you choose Toll saver, the answering system answers a call after two rings when you have new messages, or after four rings when you have no new messages. This enables you to check for new messages and avoid paying unnecessary long distance charges if you are calling from outside your local area.

Message playback

On the telephone base

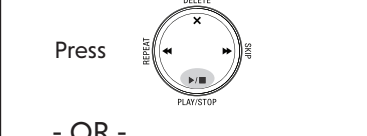

1. Press MENU. 2. Press SELECT to select Play messages.

Skip a message

On the telephone base

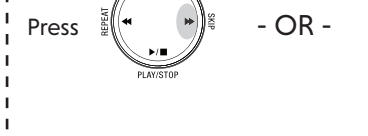

1. Press MENU. 2. Press SELECT to select Play messages.

Play the previous message

On the telephone base

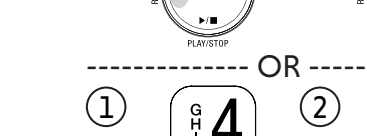

1. Press MENU. 2. Press SELECT to select Play messages.

Repeat the playing message

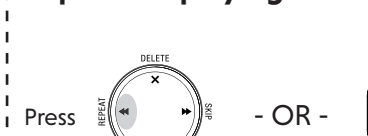

1. Press MENU. 2. Press SELECT to select Play messages.

Delete all messages

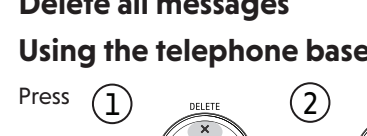

1. Press MENU. 2. Press SELECT to select Play messages.

CALL BLOCK

Call Block

If you subscribe to caller ID service, you can set the telephone to block unknown calls and certain undesired calls. The call block list can store up to 150 entries.

Add a call block entry



1. Press MENU. 2. Press SELECT to select Block list. 3. Press SELECT to select Block list. 4. Press SELECT to select Block list. 5. Enter number then press SELECT. 6. Enter name then press SELECT.

Delete a call block list entry

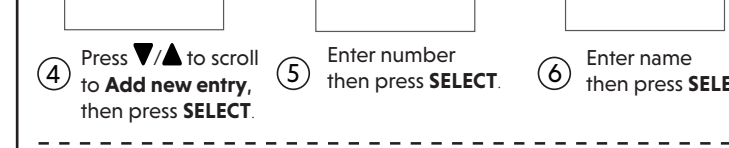

When the desired call block list entry displays on the handset screen

Press DELETE.

Block unknown calls



1. Press MENU. 2. Press SELECT to scroll to Call block, then press SELECT. 3. Press SELECT to scroll to Call w/o num, then press SELECT.

Review a call block list entry



1. Press MENU. 2. Press SELECT to scroll to Call block, then press SELECT. 3. Press SELECT to select Block list. 4. Press SELECT to select Review.

THE RBRC SEAL

The RBRC seal on the nickel-metal hydride battery indicates that Vtech Communications, Inc. is voluntarily participating in an industry program to collect and recycle these batteries at the end of their useful lives...

FCC, ACTA and IC REGULATIONS

FCC Part 15 NOTE: This equipment has been tested and found to comply with the requirements for a Class B digital device under Part 15 of the Federal Communications Commission (FCC) Rules...

FOR C-UL COMPLIANCE ONLY

- 1. Mesures de sécurité importantes. Afin de réduire les risques d'incendie, de blessures corporelles ou d'électrocution, suivez toujours ces mesures préventives de base lorsqu'il s'agit de votre téléphone.
- 2. Observez toutes les instructions et mises en garde inscrites sur l'appareil.
- 3. Débranchez ce téléphone de la prise murale avant de le nettoyer. N'utilisez pas de nettoyeurs liquides ni en aérosol.
- 4. Ne déposez pas ce téléphone sur un chariot, support ou table chancelants.
- 5. Évitez d'installer le système téléphonique dans les endroits soumis à une température extrême, à la lumière directe du soleil ou à proximité immédiate d'autres appareils électriques ou électroniques.
- 6. Ne déposez rien sur le cordon d'alimentation. Installez cet appareil dans un endroit sécuritaire, là où personne ne pourra trébucher sur la ligne d'alimentation ni le cordon téléphonique modulaire.
- 7. N'insérez jamais d'objets à travers les fentes et ouvertures de cet appareil, car ils pourraient toucher à des points de tension dangereux ou court-circuiter des pièces, ce qui pourrait entraîner un risque d'incendie ou d'électrocution.
- 8. Ne faites fonctionner cet appareil qu'avec le type d'alimentation indiqué sur les étiquettes de l'appareil.
- 9. Ne placez pas cet appareil à proximité d'un élément de chauffage ni d'une plinthe électrique.
- 10. Ne déposez rien sur le cordon d'alimentation. Installez cet appareil dans un endroit sécuritaire, là où personne ne pourra trébucher sur la ligne d'alimentation ni le cordon téléphonique modulaire.
- 11. N'insérez jamais d'objets à travers les fentes et ouvertures de cet appareil, car ils pourraient toucher à des points de tension dangereux ou court-circuiter des pièces, ce qui pourrait entraîner un risque d'incendie ou d'électrocution.
- 12. Afin de réduire les risques d'électrocution, ne démontez pas l'appareil, mais apportez-le plutôt à un centre de service qualifié s'il doit être réparé.
- 13. Ne surchargez pas les prises de courant et les rallonges.
- 14. Débranchez cet appareil de la prise de courant et communiquez avec le département de service à la clientèle de Vtech dans les cas suivants:
- 15. Évitez d'utiliser un téléphone (autre qu'un sans fil) pendant un orage.
- 16. N'utilisez pas le téléphone pour rapporter une fuite de gaz à proximité de la fuite.
- 17. Les simulateurs cardiaques (s'applique uniquement aux téléphones numériques sans fil):

- 18. Ces adaptateurs ont été conçus pour être orientés en position verticale ou montés au sol.
- 19. Pour le MATÉRIEL RACCORDÉ PAR PRISE DE COURANT, le socle de prise de courant doit être installé à proximité du matériel et doit être aisément accessible.
- 20. MISE EN GARDE! Il peut y avoir un risque d'explosion si vous utilisez le mauvais type de piles pour le téléphone.
- 21. N'utilisez que les adaptateurs inclus avec ce produit.
- 22. Conservez ces instructions.
- 23. N'utilisez que la pile incluse ou l'équivalent.
- 24. N'ouvrez pas et ne mettez pas la pile.
- 25. Soyez prudents lorsque vous manipulez les piles afin d'éviter les courts-circuits provoqués par des matériaux conducteurs.
- 26. Les piles rechargeables à l'hydruure métallique de nickel:
- 27. Les simulateurs cardiaques (s'applique uniquement aux téléphones numériques sans fil):

The Ringer Equivalence Number (REN) is used to determine how many devices you may connect to your telephone line and still have them ring when you are called. The REN for this product is encoded as the 6th and 7th characters following the US: in the product identifier (e.g., # # # 03, the REN is 0.3).

2. While you press and hold F/ FIND HANDESET, plug the telephone base power adapter back to the power outlet.

NOTE: This equipment has been tested and found to comply with the requirements for a Class B digital device under Part 15 of the Federal Communications Commission (FCC) Rules...

NOTE: This equipment has been tested and found to comply with the requirements for a Class B digital device under Part 15 of the FCC rules...

NOTE: This equipment has been tested and found to comply with the requirements for a Class B digital device under Part 15 of the FCC rules...

NOTE: This equipment has been tested and found to comply with the requirements for a Class B digital device under Part 15 of the FCC rules...

NOTE: This equipment has been tested and found to comply with the requirements for a Class B digital device under Part 15 of the FCC rules...

NOTE: This equipment has been tested and found to comply with the requirements for a Class B digital device under Part 15 of the FCC rules...

NOTE: This equipment has been tested and found to comply with the requirements for a Class B digital device under Part 15 of the FCC rules...

NOTE: This equipment has been tested and found to comply with the requirements for a Class B digital device under Part 15 of the FCC rules...

NOTE: This equipment has been tested and found to comply with the requirements for a Class B digital device under Part 15 of the FCC rules...

NOTE: This equipment has been tested and found to comply with the requirements for a Class B digital device under Part 15 of the FCC rules...

NOTE: This equipment has been tested and found to comply with the requirements for a Class B digital device under Part 15 of the FCC rules...