

Go to www.vtechphones.com to register your product for enhanced warranty support and the latest VTech product news.

DS6251
DS6251-2
DS6251-3
DS6251-4

2-Line Cordless Answering System
with Smart Call Blocker



vtech Quick start guide

1 What's in the box

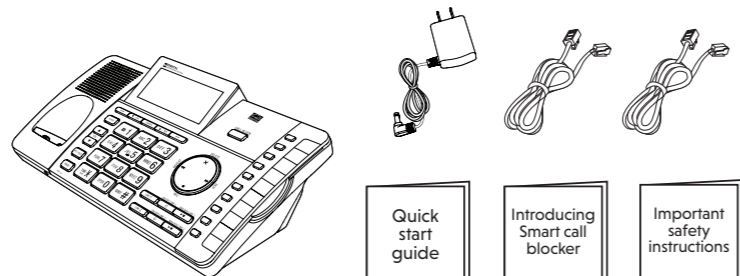

Quick start guide
Introducing Smart call blocker
Important safety instructions

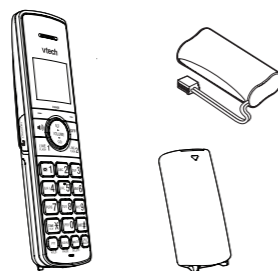

1 set for DS6251
2 sets for DS6251-2
3 sets for DS6251-3
4 sets for DS6251-4

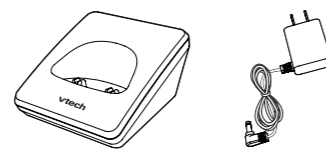

1 set for DS6251-2
2 sets for DS6251-3
3 sets for DS6251-4

1 Connect and install

1 Connect the telephone base
If you subscribe to digital subscriber line (DSL) high-speed Internet service through your telephone line, make sure you connect a DSL filter (not included) to the telephone wall jack.

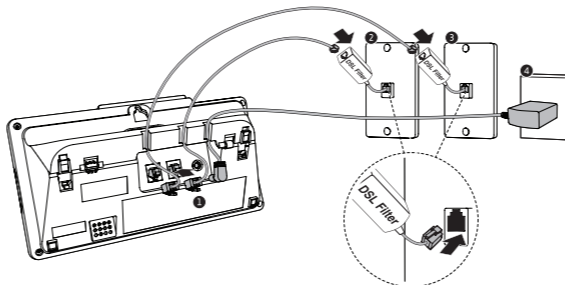

2 Install the battery

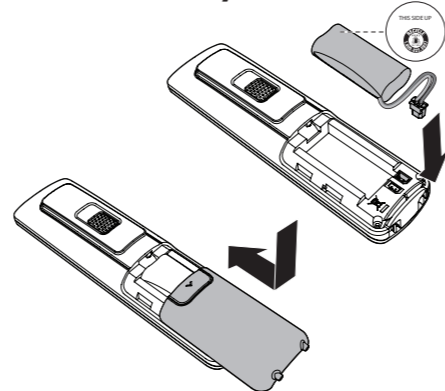

3 Connect the charger

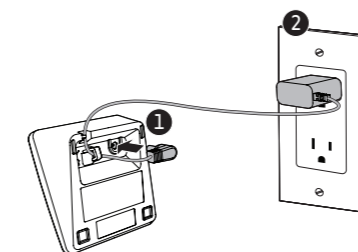

4 Charge the battery

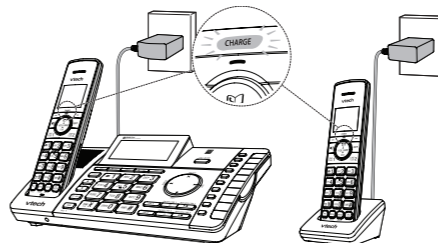

12 hrs

Display Handset:

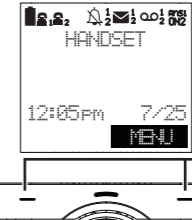

Telephone base:

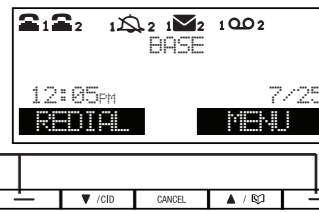

	The battery is low and needs charging.
	The battery is charging.
	The battery is fully charged.
	Line 1 or line 2 is in use.
	Handset ringer on line 1 and/or line 2 is off.
	New voicemail received on line 1 and/or line 2 from your telephone service provider.
	There are new answering system message(s) on line 1 and/or line 2.
MUTE	The microphone is muted.
NEW	New caller ID log entries.
	Option displayed above a softkey. Press or to select.

	Line 1 or line 2 is in use.
	Telephone base ringer on line 1 and/or line 2 is off.
	New voicemail received on line 1 and/or line 2 from your telephone service provider.
	There are new answering system message(s) on line 1 and/or line 2.
MUTE	The microphone is muted.
NEW	New caller ID log entries.
	Option displayed above a softkey. Press or to select.

Specifications are subject to change without notice. © 2020 Vtech Communications, Inc. All rights reserved. 06/20. DS6251-X-QSG-V2.0



2 Setup

After you install your telephone or power returns following a power outage and battery depletion, the handset and telephone base will prompt you to set the date and time, and to configure the Smart call blocker and answering system through voice guide.

Date and time

Follow the steps below to set the date and time. For example, if the date is 25 July, 2018, and the time is 12:05 PM:



When the handset and telephone base prompts you to set the date and time



Enter the date



Enter the time



Voice guide for Smart call blocker

After setting the date and time, the handset and telephone base will prompt if you want to set Smart call blocker. For more details, see **Use voice guide to set Smart call blocker** in the **Introducing Smart call blocker** leaflet.

When the handset and telephone base prompt you to set up the Smart call blocker via voice guide

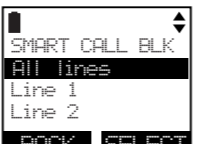
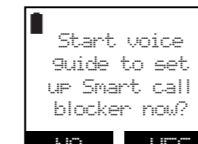

Choose to set for both lines or a specific line

"Hello! This voice guide will assist you with the basic setup of Smart call blocker"

Setup your Smart call blocker by inputting the designated numbers as instructed in the voice guide.

Voice guide for answering system

After setting the Smart call blocker, the handset and telephone base will display **Start voice guide to set up Answering system now?**

This feature assists you to do the basic setup of the answering system. You can follow the voice guide to record your own announcement, set the number of rings and the message alert tone.

When the handset and telephone base prompt you to set up the answering system via voice guide

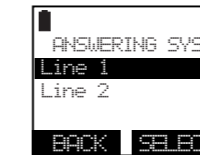
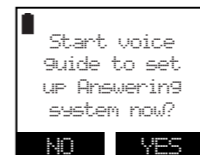

Choose a specific line

"Hello! This voice guide will assist you with the basic setup of your answering system"

Setup your answering system by inputting the designated numbers as instructed in the voice guide.

3 Operate

Make a call

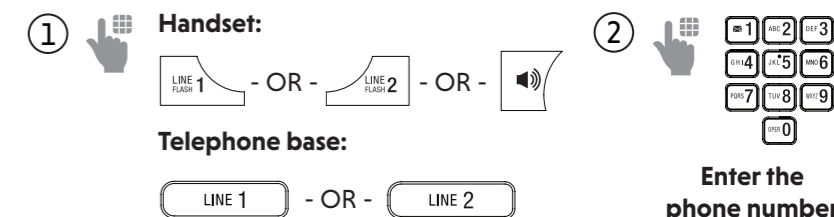

Answer a call

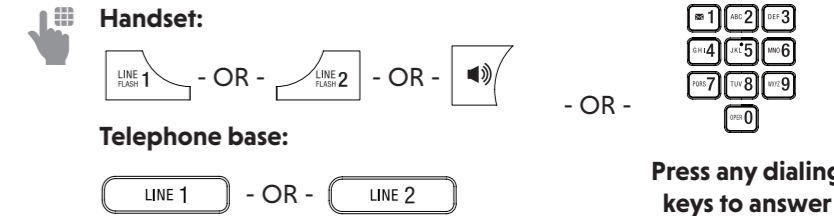

End a call

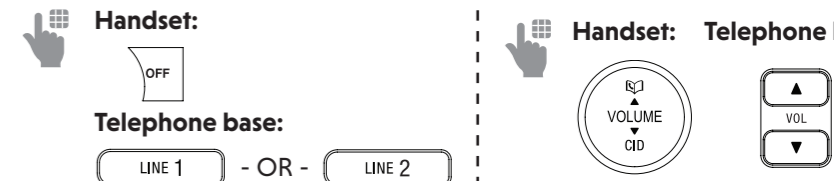

For detailed instructions, read the online user's manual or frequently asked questions at www.vtechphones.com.

TECHNICAL SPECIFICATIONS

Frequency control	Crystal controlled PLL synthesizer
Transmit frequency	Handset: 1921.536-1928.448 MHz Telephone base: 1921.536-1928.448 MHz
Channels	5
Normal effective range	Maximum power allowed by FCC and IC. Actual operating range may vary according to environmental conditions at the time of use.
Power requirement	Handset: 2.4V Ni-MH battery Telephone base: 6V DC @ 600mA Charger: 6V DC @ 400mA
Memory	Phonebook: 50 memory locations; up to 30 digits and 15 characters Caller ID log: 50 memory locations; up to 24 digits and 15 characters Call block: 1000 entries

DISCLAIMER AND LIMITATION OF LIABILITY

The ENERGY STAR program (www.energy.gov) recognizes and encourages the use of products that save energy and help protect our environment. We are proud to mark this product with the ENERGY STAR label indicating it meets the latest energy efficiency guidelines. Vtech Communications, Inc. and its suppliers assume no responsibility for any damage or loss resulting from the use of this user's manual. Vtech Communications, Inc. and its suppliers assume no responsibility for any loss or claims by third parties that may arise through the use of this product.



Caller ID

Caller ID

If you subscribe to caller ID service, information about each caller appears after the first or second ring. The caller ID log stores up to 50 entries. Each entry has up to 24 digits for the phone number and 15 characters for the name.

Review caller ID log entries

1. Press **MENU** on the handset screen. 2. Press **VOLUME** (up/down) on the telephone base screen.

Browse the entries

Dial a caller ID log entry

When your desired caller ID entry displays on the handset or telephone base screen

Handset: Press **LINE 1** - OR - **LINE 2**. **Telephone base:** Press **LINE 1** - OR - **LINE 2**.

Save a caller ID log entry to the phonebook

When your desired caller ID entry displays on the handset or telephone base screen

1. Press **SAVE**. 2. Press **SELECT**. 3. Press **BACKSP** / **NEXT**. 4. Press **NEXT**. 5. Press **SAVE**.

Phonebook

Phonebook

The phonebook can store up to 50 entries, which are shared by all handsets and the telephone base. Each entry may consist of a telephone number up to 30 digits, and a name up to 15 characters.

Add a phonebook entry

1. Press **MENU**. 2. Press **SAVE**. 3. Press **NEXT**. 4. Press **ENTER** / **NUM** keys. 5. Press **SAVE**.

Enter the name

Review phonebook entries

1. Press **VOLUME** (up/down) on the handset. 2. Press **VOLUME** (up/down) on the telephone base.

Browse the entries

Delete a phonebook entry

When your desired phonebook entry displays on the handset or telephone base screen

1. Press **DELETE**. 2. Press **YES**.

Speed dial

Speed dial

The telephone system has 10 speed dial locations where you can store the telephone numbers you wish to dial more quickly. All speed dial assignments can only be selected from the existing phonebook entries.

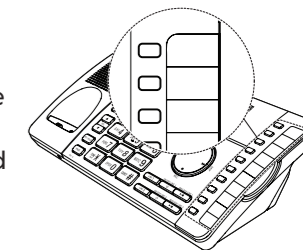

Assign a speed dial entry

1. Press **ASSIGN**. 2. Press **ASSIGN**. 3. Press **ASSIGN**.

Dial a speed dial entry

Press the corresponding speed dial key* on the telephone base to dial via the first available line.

*The 10 speed dial keys represents speed dial locations, 1-9 and 0, from top to bottom.

Smart Call Blocker

Smart call blocker

If you have subscribed to caller ID service, you can use the Smart call blocker feature to screen incoming calls. Smart call blocker is on, and to allow all incoming calls by default.

Turn the Smart call blocker on or off

1. Press **CALL BLOCK**. 2. Press **SELECT**. 3. Press **SELECT**. 4. Press **SELECT**. 5. Press **SELECT**.

For more details, refer to the **Introducing Smart call blocker** leaflet.

Answering system

About the built-in answering system and voicemail service

For message recording, your telephone has a built-in answering system, and it also supports voicemail service offered by your telephone service provider (subscription is required, and fee may apply).

Built-in answering system VS Voicemail service

	BUILT-IN ANSWERING SYSTEM	VOICEMAIL SERVICE
SUPPORTED BY	Telephone system	Telephone service provider
SUBSCRIPTION	No	Yes
FEES	No	May apply
ANSWER INCOMING CALLS	<ul style="list-style-type: none"> After 4 rings by default. It can be changed in the handset or the telephone base menu. 	<ul style="list-style-type: none"> Usually after 2 rings. It can be changed by contacting your telephone service provider.
STORAGE	Telephone base	Server or System
DISPLAY NEW MESSAGES	<ul style="list-style-type: none"> Handset - QO and XX New Msg Telephone base - QO and XX New Msg 	<ul style="list-style-type: none"> Handset - ✉ Telephone base - ✉
RETRIEVE MESSAGES	<ul style="list-style-type: none"> Press ▶/■ on the telephone base; OR Press MENU, and then select Play messages on the handset; OR Access remotely with an access code. 	<ul style="list-style-type: none"> Press V on the dialpad, and enter an access number and/or passcode from your telephone service provider.

Turn the built-in answering system on or off

ON/OFF LINE 1 - OR - ON/OFF LINE 2. Press to turn on; press again to turn off.

Message playback on the telephone base

MAILBOX LINE 1 - OR - MAILBOX LINE 2.

Skip a message

Repeat the playing message

Play the previous message

1. Press **REPEAT**. 2. Press **REPEAT**.

Delete all messages

1. Press **SELECT**. 2. Press **SELECT**. 3. Press **YES**.