

Go to www.vtechphones.com to register your product for enhanced warranty support and the latest VTech product news.

CS6648-2
CS6648-3
CS6648-4
CS6649
CS6649-2
CS6649-3

DECT 6.0 cordless telephone



vtech

Abridged user's manual

Congratulations

on purchasing your new VTech product. Before using this telephone, please read **Important safety instructions**.

This abridged user's manual provides you with basic installation and use instructions. A limited set of features are described in abbreviated form.

Please refer to the online User's manual for a full set of installation and operation instructions at www.vtechphones.com.



Telephones identified with this logo have reduced noise and interference when used with most T-coil equipped hearing aids and cochlear implants. The TIA-1083 Compliant Logo is a trademark of the Telecommunications Industry Association. Used under license.

What's in the box

Your telephone package contains the following items. Save your sales receipt and original packaging in the event warranty service is necessary.



1 set for CS6649;
2 sets for CS6648-2/CS6649-2;
3 sets for CS6648-3/CS6649-3
4 sets for CS6648-4

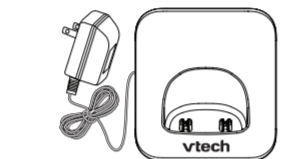

1 set for CS6648-2/CS6649-2;
2 sets for CS6648-3/CS6649-3
3 sets for CS6648-4

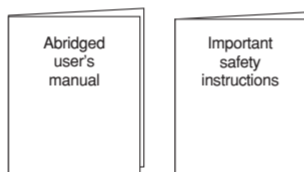

Telephone base overview



- 1 – LCD display
- 2 – IN USE light
 - On when the phone is in use, or when the answering system is answering a call.
 - On when a handset is being registered.
 - Flashes when there is an incoming call.
 - Flashes when handsets are being deregistered.
 - Flashes when another telephone on the same line is in use.
- 3 – FLASH
 - Answer an incoming call when you receive a call waiting alert.
- CANCEL
 - Return to the previous menu or idle mode without making changes.
 - Press and hold to erase the missed call indicator when the phone is not in use.
 - While the phone is ringing, press to silence the base ringer temporarily.
- ▼CID
 - Review the caller ID log when the telephone is not in use.
 - Scroll down while in a menu, or in the directory, caller ID log or redial list.
 - Move the cursor to the left when entering numbers or names.
 - Decrease the listening volume during a call or message playback.
- ▲
 - Review the directory when the phone is not in use.
 - Scroll up while in a menu, or in the directory, caller ID log or redial list.
 - Move the cursor to the right when entering numbers or names.
 - Increase the listening volume during a call or

message playback.

MENU/SELECT

- Show a menu.
- While in a menu, press to select an item, or save an entry or setting.

INT

- Press to initiate or answer an intercom call, or to transfer a call.

FIND HANDSET

- Press to page all handsets when the phone is not in use.

4 – PLAY/STOP

- Press to start or stop message playback.
- Flashes when there are new messages or memos in the answering system.

X/DELETE

- Press to delete the playing message or playing announcement.
- While reviewing the redial list, directory or caller ID log, press to delete an individual entry.
- While entering names or numbers, press to delete a character or digit.

◀REPEAT

- Press once to repeat the playing message.
- Press twice to play the previous message.

▶/SKIP

- Press to skip to the next message.

5 – MUTE

- Mute the microphone during a call.
- Silence the base ringer temporarily while the phone is ringing.

◀ANS ON/OFF

- Press to turn the built-in answering system on or off.

REDIAL/PAUSE

- Review the redial list.
- Press repeatedly to view the last 10 numbers dialed.
- Press and hold to insert a dialing pause while dialing or entering numbers.

◀/SPEAKER

- Press to make, answer or end a call.
- During a call, press to switch between the corded handset and the base speakerphone.

6 – ONE

- Press and hold to set and turn on the quiet mode, or turn it off.
- Press repeatedly to display other dialing options when reviewing a caller ID log entry.

7 – OPEN 0

- Press to enter space during text editing.

8 – TONE X

- Switch to tone dialing temporarily during a call.

9 – MIC

- Microphone.

10 – 1

- While reviewing a caller ID log entry, press repeatedly to add or remove 1 in front of the telephone number before dialing or saving it in the directory.
- Press and hold to set or dial your voicemail number.

11 – Speakerphone

12 – Corded handset

Handset overview

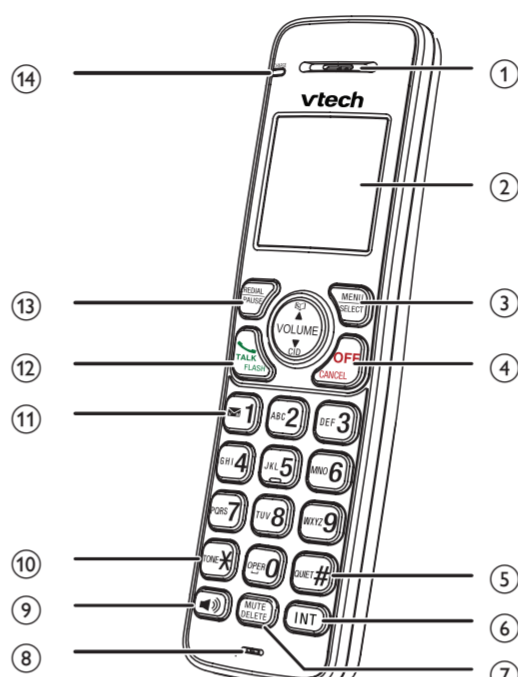

1 – Handset earpiece

2 – LCD display

3 – MENU/SELECT

- Show the menu.
- While in a menu, press to select an item or save an entry or setting.

4 – OFF

- Hang up a call.
- Return to the previous menu or idle mode without making changes.

-OR-

- Press FIND HANDSET on the telephone base.

NOTE

Do not press and hold FIND HANDSET for more than four seconds. It may lead to handset deregistration.

Intercom

Use the intercom feature for conversations between the telephone base and a cordless handset, or two cordless handsets.

- Press 7 for the telephone base or 1-5 for HANDSET 1 to HANDSET 5.
- Press 7 for the telephone base or 1-5 for HANDSET 1 to HANDSET 5.

To initiate an intercom call with a cordless handset:

1. Press INT on the cordless handset when the phone is not in use.
2. To answer the intercom call on the destination handset, press INT, or any dialing key.

-OR-

To answer the intercom call at the telephone base, press INT, or any dialing key, or lift the corded handset.

- Press OFF or place the handset in the handset charger to exit the call. The call continues until both devices hang up.

-OR-

Lift the corded handset or press ◀/SPEAKER on the telephone base.

- Place the corded handset back to the telephone base or press ◀/SPEAKER on the telephone base or press ◀/SPEAKER on the telephone base to exit the call. The call continues until both devices hang up.

Call waiting

If you subscribe to call waiting service from your telephone service provider, you hear an alert tone when there is an incoming call while you are already on a call.

- Press FLASH to put your current call on hold and take the new call.
- Press FLASH to switch back and forth between calls.

Find handset

This feature helps you find misplaced handsets.

To start paging:

- Press FIND HANDSET on the telephone base and its screen displays ** Paging **. All idle handsets ring and display ** Paging **.

To stop paging:

- Press INT, ◀, OFF or any of the dialing keys on the cordless handset.

-OR-

- Place the cordless handset to the handset charger.

Charger overview

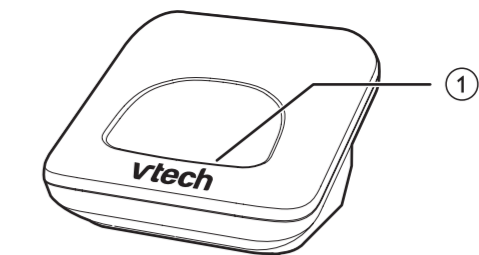

1 – Charging pole

Display icons overview

Handset display icons

	The battery icon flashes when the battery is low and needs charging.
	The battery icon animates when the battery is charging.
	The battery icon becomes solid when the battery is fully charged.
	The handset ringer is off.
	There are new voicemail received from your telephone service provider.
ANS ON	The answering system is turned on.
ECO	The ECO mode activates automatically to reduce power consumption when the handset is within range from the telephone base.
NEW	The entry you are reviewing is new in the caller ID log.
	The number of current playing message and the total number of messages recorded.

Telephone base display icons

	The telephone base ringer is off.
	There are new voicemail received from your telephone service provider.
NEW	The entry you are reviewing is new in the caller ID log.
	<ul style="list-style-type: none"> • The total number of messages recorded when the telephone base is not in use. • The number of the playing message.

Connect

You can choose to connect the telephone base for desktop usage or wall mounting.

NOTES

- Use only the adapters provided.
- Make sure the electrical outlets are not controlled by wall switches.
- The adapters are intended to be correctly oriented in a vertical or floor mount position. The prongs are not designed to hold the plug in place if it is plugged into a ceiling, under-the-table or cabinet outlet.

TIP

- If you subscribe to digital subscriber line (DSL) high-speed Internet service through your telephone line, make sure you install a **DSL filter** (not included) between the telephone line cord and telephone wall jack. Contact your DSL service provider for more information.

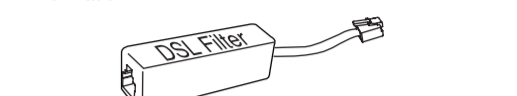

Connect the telephone base

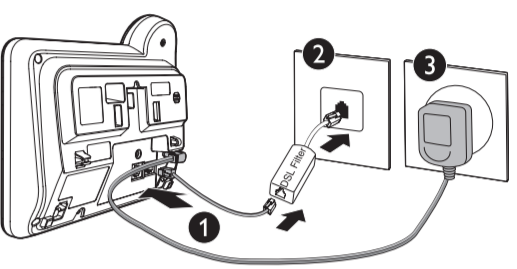

Mount the telephone base

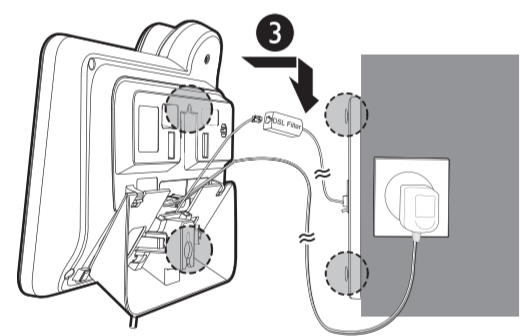
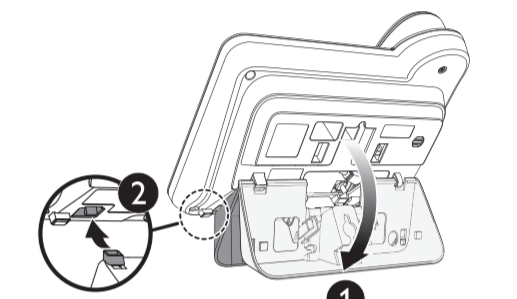

Install and charge the battery

Install the battery as shown below.

NOTES

- Use only supplied battery.
- Charge the battery provided with this product only in accordance with the instructions and limitations specified in this manual.
- If the handset will not be used for a long time, disconnect and remove the battery to prevent possible leakage.

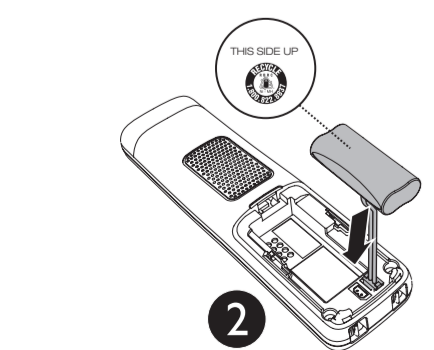
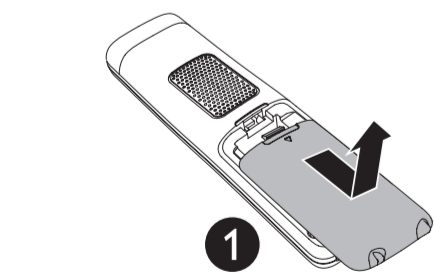

Connect the charger and charge the battery

Place the handset in the telephone base or handset charger to charge.

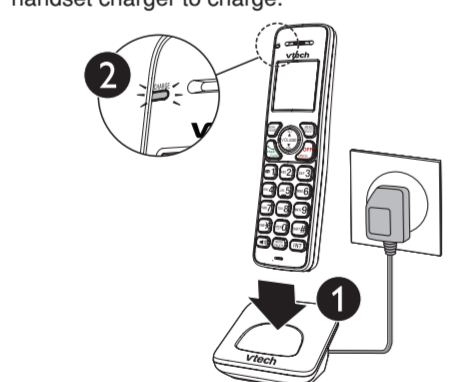

Once you have installed the battery, the handset LCD display indicates the battery status (see the table on next page).

NOTES

- For best performance, keep the handset in the telephone base or charger when not in use.
- The battery is fully charged after 11 hours of continuous charging.
- If you place the handset in the telephone base or the charger without plugging in the battery, the screen displays **NO BATTERY**.

Battery indicators	Battery status	Action
The screen is blank, or displays Put in charger and	The battery has no or very little charge. The handset cannot be used.	Charge without interruption (about 30 minutes).
The screen displays Low battery and	The battery has enough charge to be used for a short time.	Charge without interruption (about 30 minutes).
The screen displays HANDSET X .	The battery is charged.	To keep the battery charged, place it in the handset charger when not in use.

Before use

After you install your telephone or power returns following a power outage, the handset will prompt you to set the date and time.

Set date and time

NOTE

Make sure you set the date and time including the year correctly; otherwise the answering system does not announce the correct day of the week for your recorded messages time stamp.

1. Use the dialing keys (0-9) to enter the month (MM), date (DD) and year (YY). Then press SELECT.

2. Use the dialing keys (0-9) to enter the hour (HH) and minute (MM). Then press ▼ or ▲ to choose AM or PM.
3. Press SELECT to save.

Check for dial tone

Press TALK. If you hear a dial tone, the installation is successful.

If you do not hear a dial tone:

- Make sure the installation procedures described above are properly done.
- It may be a wiring problem. If you have changed your telephone service to digital service from a cable company or a VoIP service provider, the telephone line may need to be rewired to allow all existing telephone jacks to work. Contact your cable/VoIP service provider for more information.

Operating range

This cordless telephone operates with the maximum power allowed by the Federal Communications Commission (FCC). Even so, this handset and telephone base can communicate over only a certain distance - which can vary with the locations of the telephone base and handset, the weather, and the layout of your home or office.

When the handset is out of range, the handset displays **Out of range** or **no pwr at base**.

If there is a call while the handset is out of range, it may not ring, or if it does ring, the call may not connect well when you press TALK. Move closer to the telephone base, then press TALK to answer the call.

If the handset moves out of range during a telephone conversation, there may be interference. To improve reception, move closer to the telephone base.

Using the telephone base/handset menu

You can use the telephone base or a cordless handset to change your telephone settings.

1. Press MENU when the phone is not in use.
2. Press ▼ or ▲ until the screen displays the desired feature menu.
3. Press SELECT to enter that menu.

- To return to the previous menu, press CANCEL.
- To return to idle mode, press and hold CANCEL.

Configure your telephone

Set language

The LCD language is preset to English. You can select English, French or Spanish to be used in all screen displays.

1. Press MENU when the handset/telephone base is not in use.
2. Press ▼ or ▲ to scroll to **Settings**, then press SELECT.
3. Press SELECT to select **LCID language**.
4. Press ▼ or ▲ to select **English**, **Français** or **Español**, then press SELECT.

Set date and time

NOTE

Make sure you set the date and time including the year correctly; otherwise the answering system does not announce the correct day of the week for your recorded messages time stamp.

1. Press MENU when the handset/telephone base is not in use.
2. Press ▼ or ▲ to scroll to **Set date/time**, then press SELECT.
3. Use the dialing keys (0-9) to enter the month (MM), date (DD) and year (YY). Then press SELECT.

4. Use the dialing keys (0-9) to enter the hour (HH) and minute (MM). Then press ▼ or ▲ to choose AM or PM.
5. Press SELECT.

Temporary tone dialing

If you have pulse (rotary) service only, you can switch from pulse to touch-tone dialing temporarily during a call.

1. During a call, press TONEX.

2. Use the dialing keys to enter the number you wish to dial. The telephone sends touch-tone signals. It automatically returns to pulse dialing mode after you end the call.

Telephone operations

Make a call

- Press TALK or ◀ on the handset and then dial the number.

-OR-

- Lift the corded handset, or press ◀/SPEAKER on the telephone base, then dial the number.

Answer a call

- Press TALK, ◀ or any of the dialing keys on the handset.

-OR-

- Lift the corded handset, or press ◀/SPEAKER or any of the dialing keys on the telephone base.

End a call

- Press OFF on the handset or place the handset in the handset charger.

-OR-

1. When you are using the corded handset, place it on the telephone base.
2. When you are using the base speakerphone, press ◀/SPEAKER.

Speakerphone

- When the cordless handset is on a call, press ◀/SPEAKER on the telephone base to switch between the telephone base speakerphone and the handset earpiece.

-OR-

- When the corded handset is on a call, press ◀/SPEAKER on the telephone base to switch between the telephone base speakerphone and the corded handset.

Volume

- During a call, press ▲/VOLUME or ▼/VOLUME on the handset, or press ▼ VOL or VOL ▲ on the telephone base to adjust the listening volume.

Mute

The mute function allows you to hear the other party but the other party cannot hear you.

1. During a call, press MUTE on the handset. The handset displays **Muted** until the mute function is turned off.

2. Press MUTE on the handset again to resume the conversation. The handset displays **Microphone** on briefly.

-OR-

1. During a call, press MUTE on the telephone base. The telephone base displays **Muted** and the MUTE light turns on until the mute function is turned off.

2. Press MUTE on the telephone base again to resume the conversation. The telephone base displays **Microphone** on briefly.

Redial list

Each handset and the telephone base store the last 10 telephone numbers dialed. When there are already 10 entries,

